

RESOLUTION NO 1288

A RESOLUTION OF THE CITY COUNCIL OF THE
CITY OF REDMOND, WASHINGTON, RATIFYING
THE 2009 AMENDMENTS TO THE KING COUNTY
COUNTYWIDE PLANNING POLICIES

WHEREAS, the Growth Management Act requires King County to prepare and maintain Countywide Planning Policies, and

WHEREAS, King County and the cities in the county have prepared an interlocal agreement providing that the King County Countywide Planning Policies and amendments to the policies must be ratified by at least 30 percent of the local governments representing 70 percent of the population of King County before they are adopted, and

WHEREAS, King County and the cities in King County prepared and adopted the Countywide Planning Policies in 1992 and have amended the policies from time to time, and

WHEREAS, the King County Council has adopted amendments to the Countywide Urban Growth Area Boundary Map, the Potential Annexation Areas Map, and the Countywide Urban Separator Map which involve the cities of Carnation, Duvall, Sammamish, Bellevue, Issaquah, Renton, Enumclaw, Maple Valley and Black Diamond, and

WHEREAS, these amendments will benefit the region by supporting the eventual annexation of these areas by cities

NOW, THEREFORE, THE CITY COUNCIL OF THE CITY OF REDMOND, WASHINGTON, HEREBY RESOLVES that the 2009 Amendments to the King County Countywide Planning Policies set forth in Exhibit 1 attached hereto and incorporated herein by this reference as if set forth in full are hereby ratified by the City of Redmond

ADOPTED by the Redmond City Council this 17th day of March, 2009

CITY OF REDMOND

MAYOR JOHN MARCHIONE

ATTEST

MICHELLE M MCGEHEE, CMC, CITY CLERK

(SEAL)

FILED WITH THE CITY CLERK	March 11, 2009
PASSED BY THE CITY COUNCIL	March 17, 2009
SIGNED BY THE MAYOR	March 17, 2009
EFFECTIVE DATE	March 17, 2009
RESOLUTION NO <u>1288</u>	

PASSED (7-0) Allen, Carson Cole Margeson, McCormick, Myers and Vache



KING COUNTY

1200 King County Courthouse
516 Third Avenue
Seattle WA 98104

Signature Report

December 15, 2008

Ordinance 16334

Proposed No 2008-0620 2

Sponsors Gossett

1 AN ORDINANCE adopting amendments to the
 2 Countywide Planning Policies, amending the interim
 3 potential annexation areas map and ratifying the amended
 4 Countywide Planning Policies for unincorporated King
 5 County, and amending Ordinance 10450, Section 3, as
 6 amended, and K C C 20 10 030 and Ordinance 10450,
 7 Section 4, as amended, and K.C C 20 10 040

8
9 **BE IT ORDAINED BY THE COUNCIL OF KING COUNTY**

10 **SECTION 1 Findings The council makes the following findings**

11 **A The Growth Management Planning Council met on September 17, 2008 and**
 12 **voted to recommend amendments to the King County Countywide Planning Policies,**
 13 **amending the interim potential annexation areas map as shown in Attachment A to this**
 14 **ordinance to include a portion of unincorporated urban area within the Potential**
 15 **Annexation Area of the city of Maple Valley The Growth Management Planning**
 16 **Council also voted to recommend amendments to the King County Countywide Planning**

17 Policies, amending the interim potential annexation areas maps as shown in Attachment
18 B to this ordinance

19 B As part of the King County council's review of the 2008 comprehensive plan
20 updates, the council considered the recommended amendments set for in Attachment B to
21 this ordinance. In approving the 2008 updates to the King County Comprehensive Plan
22 the council adopted all of the recommended amendments in Attachment B to this
23 ordinance except for the following: (1) item 12, relating to the expansion of the urban
24 growth area near the I-90 / Highway 18 interchange and adding that area to the city of
25 Snoqualmie's Potential Annexation Area, and (2) item 14, relating to the expansion of the
26 urban growth area referred to as "Duthie Hill" and adding that area to the city of
27 Sammamish's Potential Annexation Area

28 SECTION 2 Ordinance 10450, Section 3, as amended, and K C C 20 10 030 are
29 each hereby amended to read as follows

30 A The Phase II Amendments to the King County 2012 Countywide Planning
31 Policies attached to Ordinance 11446 are hereby approved and adopted

32 B The Phase II Amendments to the King County 2012 - Countywide Planning
33 Policies are amended, as shown by Attachment 1 to Ordinance 12027

34 C The Phase II Amendments to the King County 2012 - Countywide Planning
35 Policies are amended, as shown by Attachment 1 to Ordinance 12421

36 D The Phase II Amendments to the King County 2012 - Countywide Planning
37 Policies are amended, as shown by Attachments 1 and 2 to Ordinance 13260

38 E The Phase II Amendments to the King County 2012 - Countywide Planning
39 Policies are amended as shown by Attachments 1 through 4 to Ordinance 13415

40 F The Phase II Amendments to the King County 2012 - Countywide Planning
41 Policies are amended, as shown by Attachments 1 through 3 to Ordinance 13858

42 G The Phase II Amendments to the King County 2012 – Countywide Planning
43 Policies are amended, as shown by Attachment 1 to Ordinance 14390

44 H The Phase II Amendments to the King County 2012 – Countywide Planning
45 Policies are amended, as shown by Attachment 1 to Ordinance 14391

46 I The Phase II Amendments to the King County 2012 – Countywide Planning
47 Policies are amended, as shown by Attachment 1 to Ordinance 14392

48 J The Phase II Amendments to the King County 2012 - Countywide Planning
49 Policies are amended, as shown by Attachment 1 to Ordinance 14652

50 K The Phase II Amendments to the King County 2012 - Countywide Planning
51 Policies are amended, as shown by Attachments 1 through 3 to Ordinance 14653

52 L The Phase II Amendments to the King County 2012 - Countywide Planning
53 Policies are amended, as shown by Attachment 1 to Ordinance 14654

54 M The Phase II Amendments to the King County 2012 - Countywide Planning
55 Policies are amended, as shown by Attachment 1 to Ordinance 14655

56 N The Phase II Amendments to the King County 2012 - Countywide Planning
57 Policies are amended, as shown by Attachments 1 and 2 to Ordinance 14656

58 O The Phase II amendments to the King County 2012 – Countywide Planning
59 Policies are amended, as shown by Attachment A to Ordinance 14844

60 P The Phase II Amendments to the King County 2012 - Countywide Planning
61 Policies are amended as shown by Attachments A, B and C to Ordinance 15121

62 Q The Phase II Amendments to the King County 2012 - Countywide Planning

63 Policies are amended, as shown by Attachment A to Ordinance 15122

64 R The Phase II Amendments to the King County 2012 - Countywide Planning

65 Policies are amended, as shown by Attachment A to Ordinance 15123

66 S Phase II Amendments to the King County 2012 - Countywide Planning

67 Policies are amended, as shown by Attachments A and B to Ordinance 15426

68 T Phase II Amendments to the King County 2012 - Countywide Planning

69 Policies are amended, as shown by Attachments A, B and C to Ordinance 15709

70 U Phase II Amendments to the King County 2012 - Countywide Planning

71 Policies are amended, as shown by Attachment A to Ordinance 16056

72 V Phase II Amendments to the King County 2012 - Countywide Planning

73 Policies are amended, as shown by Attachments A, B, C, D, E and F to Ordinance 16151

74 W Phase II Amendments to the King County 2012 - Countywide Planning

75 Policies are amended as shown by Attachment A to this ordinance, and those items

76 numbered 1 through 11, 13 and 15, as shown on Attachment B to this ordinance, are

77 hereby ratified on behalf of the population of unincorporated King County. Those items

78 numbered 12 and 14, shown as struck-through on Attachment B to this ordinance, are not

79 ratified.

80 SECTION 3 Ordinance 10450, Section 4, as amended, and K.C.C. 20 10 040 are

81 each hereby amended to read as follows

82 A Countywide Planning Policies adopted by Ordinance 10450 for the purposes

83 specified are hereby ratified on behalf of the population of unincorporated King County

84 B The amendments to the Countywide Planning Policies adopted by Ordinance

85 10840 are hereby ratified on behalf of the population of unincorporated King County

86 C The amendments to the Countywide Planning Policies adopted by Ordinance
87 11061 are hereby ratified on behalf of the population of unincorporated King County

88 D The Phase II amendments to the King County 2012 Countywide Planning
89 Policies adopted by Ordinance 11446 are hereby ratified on behalf of the population of
90 unincorporated King County

91 E The amendments to the King County 2012 - Countywide Planning Policies, as
92 shown by Attachment 1 to Ordinance 12027 are hereby ratified on behalf of the
93 population of unincorporated King County

94 F The amendments to the King County 2012 - Countywide Planning Policies, as
95 shown by Attachment 1 to Ordinance 12421, are hereby ratified on behalf of the
96 population of unincorporated King County

97 G The amendments to the King County 2012 - Countywide Planning Policies, as
98 shown by Attachments 1 and 2 to Ordinance 13260, are hereby ratified on behalf of the
99 population of unincorporated King County

100 H The amendments to the King County 2012 - Countywide Planning Policies, as
101 shown by Attachment 1 through 4 to Ordinance 13415, are hereby ratified on behalf of
102 the population of unincorporated King County

103 I The amendments to the King County 2012 - Countywide Planning Policies as
104 shown by Attachments 1 through 3 to Ordinance 13858, are hereby ratified on behalf of
105 the population of unincorporated King County

106 J The amendments to the King County 2012 - Countywide Planning Policies, as
107 shown by Attachment 1 to Ordinance 14390, are hereby ratified on behalf of the
108 population of unincorporated King County

109 K The amendments to the King County 2012 - Countywide Planning Policies, as
110 shown by Attachment 1 to Ordinance 14391, are hereby ratified on behalf of the
111 population of unincorporated King County

112 L The amendments to the King County 2012 - Countywide Planning Policies, as
113 shown by Attachment 1 to Ordinance 14392, are hereby ratified on behalf of the
114 population of unincorporated King County

115 M The amendments to the King County 2012 - Countywide Planning Policies, as
116 shown by Attachment 1 to Ordinance 14652, are hereby ratified on behalf of the
117 population of unincorporated King County

118 N The amendments to the King County 2012 - Countywide Planning Policies, as
119 shown by Attachments 1 through 3 to Ordinance 14653 are hereby ratified on behalf of
120 the population of unincorporated King County

121 O The amendments to the King County 2012 - Countywide Planning Policies, as
122 shown by Attachment 1 to Ordinance 14654, are hereby ratified on behalf of the
123 population of unincorporated King County

124 P The amendments to the King County 2012 - Countywide Planning Policies, as
125 shown by Attachment 1 to Ordinance 14655, are hereby ratified on behalf of the
126 population of unincorporated King County

127 Q The amendments to the King County 2012 - Countywide Planning Policies, as
128 shown by Attachments 1 and 2 to Ordinance 14656, are hereby ratified on behalf of the
129 population of unincorporated King County

130 R The amendments to the King County 2012 – Countywide Planning Policies as
131 shown by Attachment A to Ordinance 14844 are hereby ratified on behalf of the
132 population of unincorporated King County

133 S The amendments to the King County 2012 - Countywide Planning Policies, as
134 shown by Attachments A, B and C to Ordinance 15121, are hereby ratified on behalf of
135 the population of unincorporated King County

136 T The amendments to the King County 2012 - Countywide Planning Policies, as
137 shown by Attachment A to Ordinance 15122, are hereby ratified on behalf of the
138 population of unincorporated King County

139 U The amendments to the King County 2012 - Countywide Planning Policies, as
140 shown by Attachment A to Ordinance 15123, are hereby ratified on behalf of the
141 population of unincorporated King County

142 V The amendments to the King County 2012 - Countywide Planning Policies, as
143 shown by Attachments A and B to Ordinance 15426, are hereby ratified on behalf of the
144 population of unincorporated King County

145 W The amendments to the King County 2012 - Countywide Planning Policies,
146 as shown by Attachments A, B and C to Ordinance 15709, are hereby ratified on behalf
147 of the population of unincorporated King County

148 X The amendments to the King County 2012 - Countywide Planning Policies, as
149 shown by Attachment A to Ordinance 16056, are hereby ratified on behalf of the
150 population of unincorporated King County

151 Y The amendments to the King County 2012 - Countywide Planning Policies, as

Ordinance 16334

152 shown by Attachments A, B, C, D, E and F to Ordinance 16151, are hereby ratified on
153 behalf of the population of unincorporated King County

154 Z. The amendments to the King County 2012 - Countywide Planning Policies, as
155 shown by Attachment A to this ordinance, and those items numbered 1 through 11, 13
156 and 15, as shown on Attachment B to this ordinance, are hereby ratified on behalf of the

157

Ordinance 16334

158 population of unincorporated King County Those items numbered 12 and 14, shown as

159 struck-through on Attachment B to this ordinance, are not ratified

160

Ordinance 16334 was introduced on 12/8/2008 and passed by the Metropolitan King County Council on 12/15/2008, by the following vote

Yes 7 - Ms Patterson, Mr Constantine Ms Lambert Mr von Reichbauer,
Mr Ferguson Mr Gossett and Mr Phillips
No 0
Excused 2 - Mr Dunn and Ms Hague

KING COUNTY COUNCIL
KING COUNTY WASHINGTON

Julia Patterson Chair

ATTEST

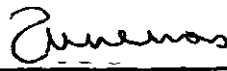
Anne Norris Clerk of the Council

APPROVED this 23 day of December 2008 
Ron Sims County Executive

RECEIVED
2008 DEC 24 AM 9 00
CLERK
KING COUNTY COUNCIL

Attachments A Motion 08-5 B Motion 08-6

9/17/08

Sponsored By Executive Committee

/pr

1
2
3
4
5
6
7
8
9
10
11
12
13
14
15
16
17
18
19
20
21
22
23
24
25
26
27
28
29
30
31
32
33
34

MOTION NO. 08-5

A MOTION to amend the interim Potential Annexation Area map in the Countywide Planning Policies

WHEREAS, Countywide Planning Policies LU-31 and LU-32 anticipate the collaborative designation of Potential Annexation Areas (PAA) and the eventual annexation of these areas by cities.

WHEREAS the attached PAA map amendment removes an unincorporated urban area not within the PAA of any city and adds this area to the City of Maple Valley PAA.

WHEREAS the attached PAA map amendment is supported by the City of Maple Valley and King County

BE IT RESOLVED THAT THE GROWTH MANAGEMENT PLANNING COUNCIL OF KING COUNTY HEREBY MOVES AS FOLLOWS

- 1 Amend the Interim Potential Annexation Area Map by including the unincorporated urban area shown on attachment A of this motion, within the Potential Annexation Area of the City of Maple Valley**
- 2 This amendment is recommended to the Metropolitan King County Council and the Cities of King County for adoption and ratification.**

ADOPTED by the Growth Management Planning Council of King County on September 17, 2008 in open session, and signed by the chair of the GMPC



Ron Sims, Chair Growth Management Planning Council

09/17/08

Sponsored By Executive Committee

/pr

1
2
3
4
5
6
7
8
9
10
11
12
13
14
15
16
17
18
19
20
21
22
23
24
25
26
27
28
29
30
31
32
33
34
35
36

MOTION NO 08-6

A MOTION to amend the Urban Growth Area of King County This Motion also modifies the Potential Annexation Area map in the Countywide Planning Policies and designates a new Urban Separator

WHEREAS, the Washington State Growth Management Act, RCW 36 70A.110 requires counties to designate an urban growth area or areas within which urban growth shall be encouraged and outside of which growth can occur only if it is not urban in nature; and

WHEREAS, Countywide Planning Policy FW-1 Step 8 recognizes that King County may initiate amendments to the Urban Growth Area, and

WHEREAS, the King County Executive and the Metropolitan King County Council requests the Growth Management Planning Council consider the attached amendments to the Urban Growth Area for eventual adoption by the Metropolitan King County Council and ratification by the cities; and

WHEREAS, the Growth Management Planning Council has directed the interjurisdictional staff team to review additional Urban Separators and present them for GMPC consideration, and

WHEREAS, Countywide Planning Policies LU-31 and LU-32 anticipate the collaborative designation of Potential Annexation Areas and the eventual annexation of these areas by cities The attached amendments are supported by the affected city

BE IT RESOLVED THAT THE GROWTH MANAGEMENT PLANNING COUNCIL OF KING COUNTY HEREBY MOVES AS FOLLOWS

- 1 Amend the Urban Growth Area as designated by the Urban Growth Areas Map in the Countywide Planning Policies, the Potential Annexation Area map, and the Urban Separator map as depicted on the following attached maps

1
2
3
4
5
6
7
8
9
10
11
12
13
14
15
16
17
18
19
20
21
22
23
24
25
26
27
28
29
30
31
32
33
34
35
36
37

- Attachment 1, Carnation
- Attachment 2, Sammamish North
- Attachment 3, Bellevue Coal Creek
- Attachment 4, Enumclaw Fairgrounds
- Attachment 5, Maple Valley Rock Creek
- Attachment 6, Black Diamond Crow Marsh
- Attachment 7, Maple Valley Dorre Don Reach
- Attachment 8, Bear Creek Kathryn Taylor Park
- Attachment 9, Maple Valley Technical Correction
- Attachment 10 Black Diamond Technical Correction
- Attachment 11, Lake Desure Urban Separator
- ~~Attachment 12, Snoqualmie Interchange~~
- Attachment 13, Eastridge Christian Assembly
- ~~Attachment 14, Duthie Hill Notch~~
- Attachment 15 Duvall UGA

- 2 Amend the Interim Potential Annexation Area Map by including any additional unincorporated urban land created by these UGA amendments in the Potential Annexation Area of the adjoining city and deleting any land changed from urban to rural from the respective PAA.
- 3 Amend the Urban Separator map by adding the new Urban Separator in the area known as Lake Desure as shown on attachment 11
- 4 These amendments are recommended to the Metropolitan King County Council and the Cities of King County for adoption and ratification.

ADOPTED by the Growth Management Planning Council of King County in open session on September 17, 2008 and signed by the chair of the GMPC.



Ron Sims, Chair, Growth Management Planning Council



Carnation Rural City Urban Growth Area Study

Land Use Map



This information included on this map has been compiled by King County and from various sources and is subject to change without notice. King County neither endorses nor represents the accuracy, reliability or content, or the quality, condition, timeliness, or rights to the use of such information. This document is not intended to serve as a warranty product. King County does not intend to be liable for any goods, services, products, or information, or any damages resulting from the use or reliance of the information contained on this map. Any sale or use of this information on any way is prohibited and will be without limitation of King County.



- ag Agriculture
- rr Rural Residential
- rx Rural City UGA
- os Open Space/ Recreation

- Incorporated Areas
- Urban Growth Boundary
- Area Added to UGA
- Proposed Urban Growth Boundary

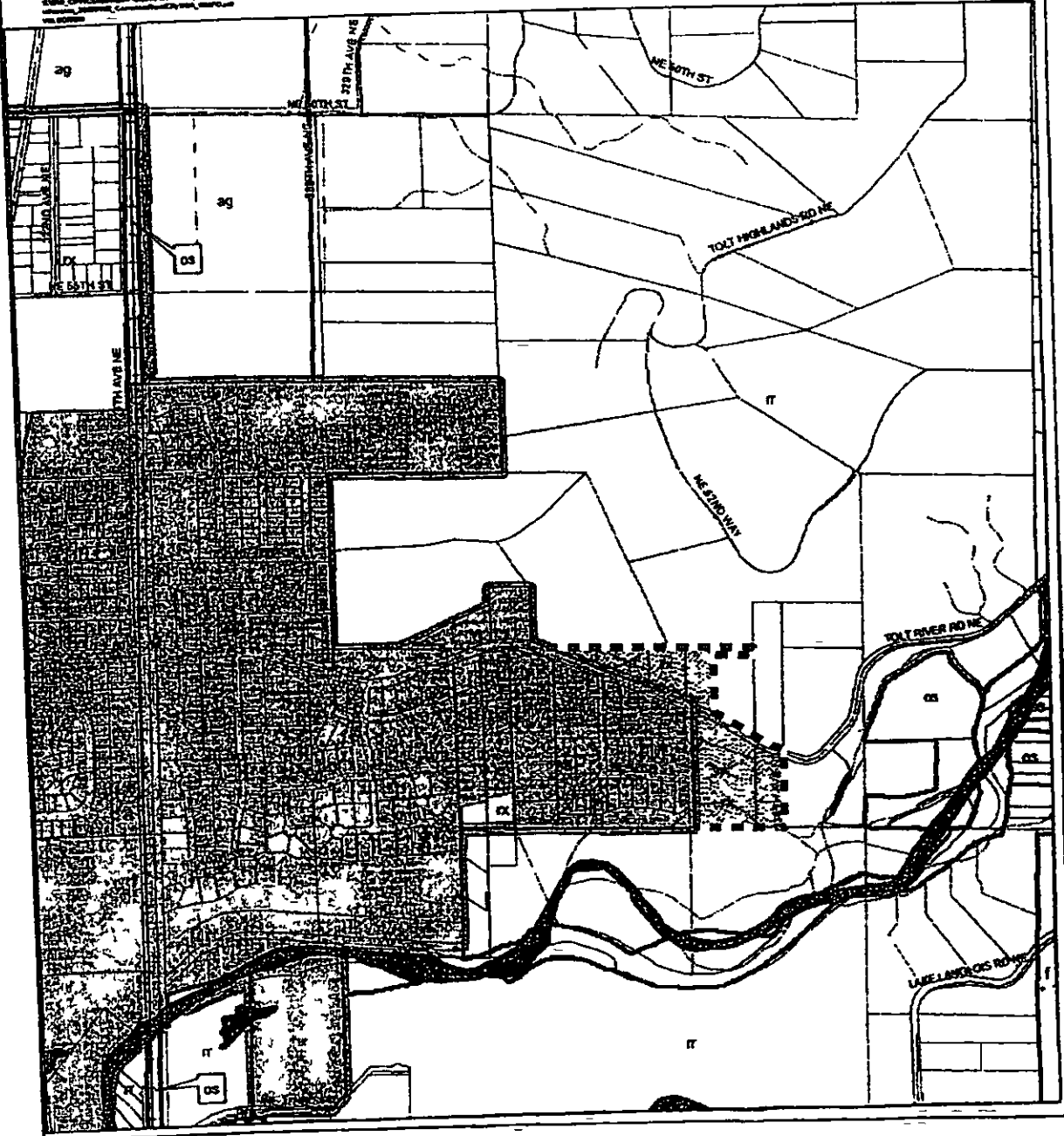



Sammamish Urban Growth Area Study - North Section Land Use Map



This information contained on this map has been compiled by King County and does not constitute a warranty or guarantee of accuracy or reliability. King County makes no representation or warranty, in whole or in part, as to the accuracy, completeness, or timeliness of the information contained on this map. King County shall not be liable for any damages, including but not limited to, consequential or incidental damages, arising from the use or reliance on the information contained on this map. King County is not responsible for any errors or omissions on this map or for any consequences that may result from the use of this map.

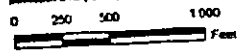

DATE: 10/20/2011
BY: [Illegible]
FOR: [Illegible]

- Incorporated Areas
- Urban Growth Boundary
- Area Added to UGA
- Proposed Urban Growth Boundary

- rr Rural residential
- os King County Owned Open Space/Recreation
- um Urban residential Medium 4-12du/ac
- ul Urban Residential Low 1du/acre

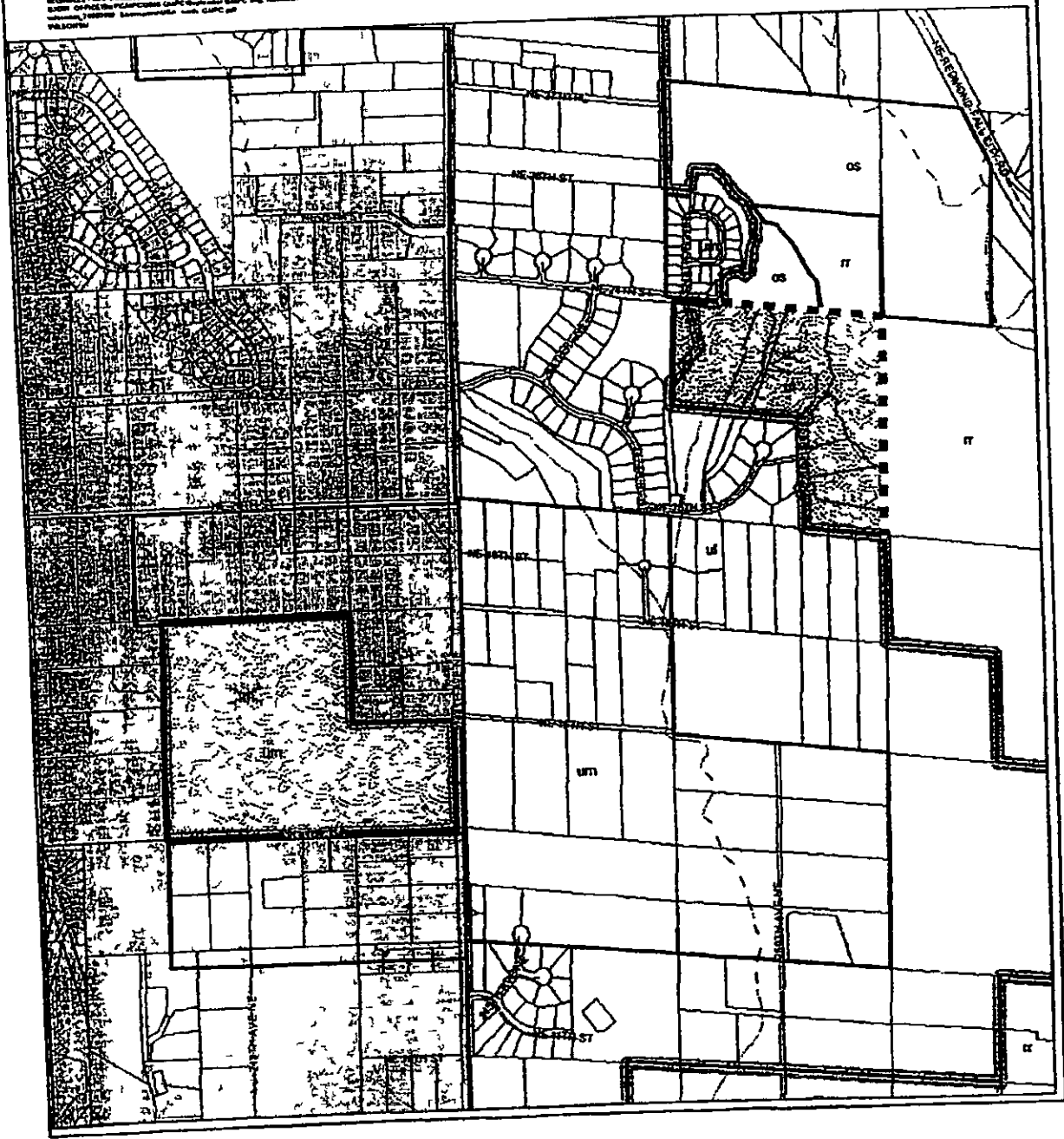



Coal Creek Park Land Use Map



This information contained on this map has been adopted by King County 2008. It is subject to change without notice. King County makes no representation or warranty, expressed or implied, as to the accuracy, completeness, or timeliness of the information. This document is intended for use as a reference only. King County shall not be liable for any general or special liability, damages, or compensation, including but not limited to, lost revenues or lost profits, resulting from the use or misuse of the information contained on this map. Any sale of this map or information on this map is prohibited except by written permission of King County.



Scale: North Arrow: 2008 2:30 PM
B:\GIS\Projects\2008\20080201\CoalCreekPark_LandUseMap.aprx
B:\GIS\Projects\2008\20080201\CoalCreekPark_LandUseMap.aprx
Author: 20080201, 20080201, 20080201, 20080201



Incorporated Areas



Urban Growth Boundary



Proposed Urban Growth Boundary



Area Added to UGA

UM Urban Residential Medium 4-12du/acre

U1 Urban Residential Low 1du/acre

OS Open Space/ Recreation

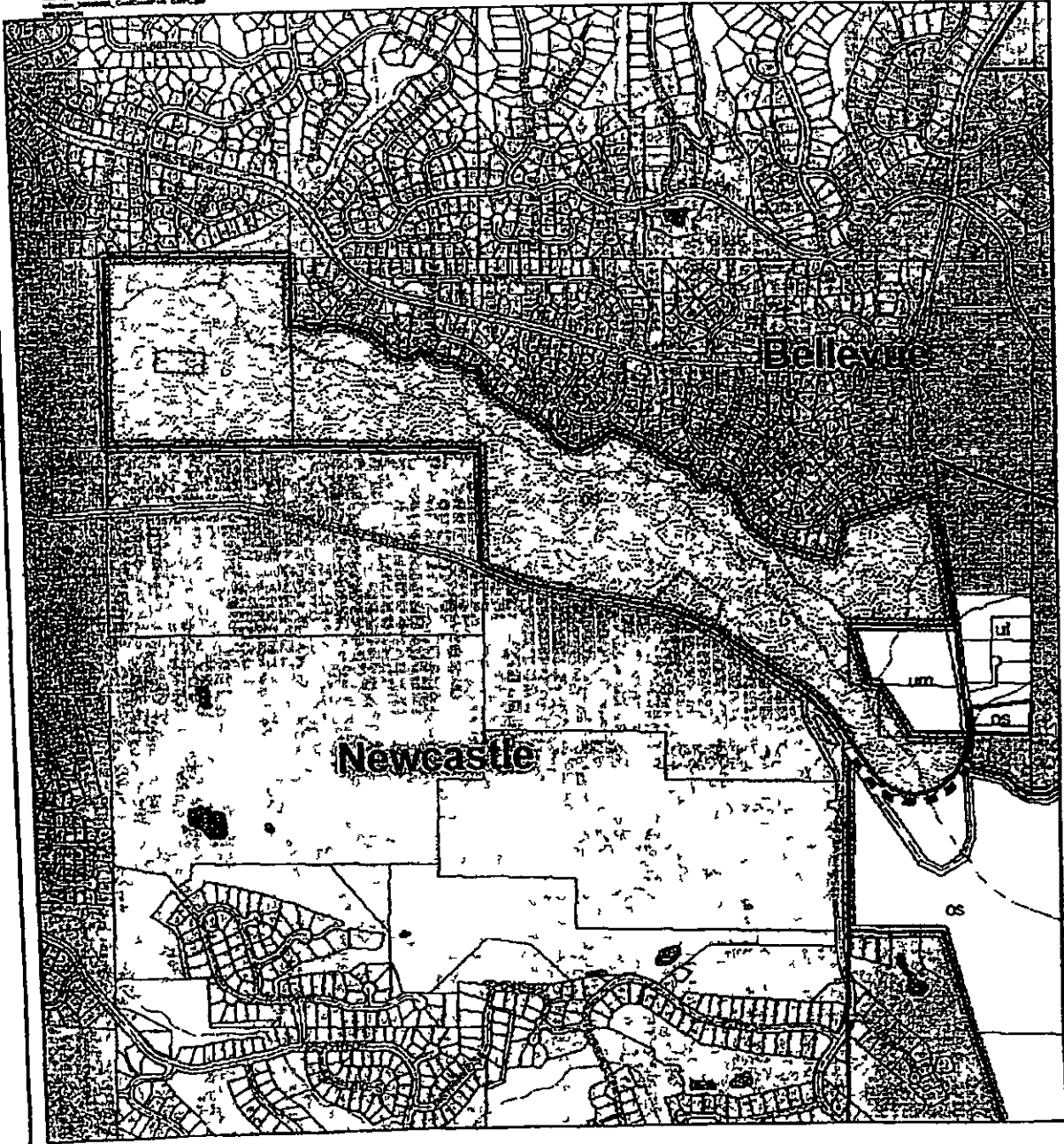



Enumclaw Fairgrounds Rural City Urban Growth Area Study

Land Use Map



The information indicated on this map has been compiled by King County staff from a variety of sources and is subject to change without notice. King County makes no representation or warranty, express or implied, as to accuracy, completeness, timeliness, or rights to the use of such information. This document is not intended for use as a survey product. King County shall not be liable for any general, special, indirect, incidental, or consequential damages including, but not limited to, lost revenues or lost profits resulting from the use or reliance on the information contained on this map. Any sale of this map or information on this map is prohibited except by written permission of King County.



Drawn: [illegible], [illegible] 8, 2009 12:00:00 PM
M:\GIS\Projects\2009\20090808\EnumclawFairgrounds_CDFPC\Map
[illegible]_20090808_EnumclawFairgrounds_CDFPC_Map_Mark
[illegible].mxd

- rr Rural Residential
- rx Rural City UGA
- os King County Owned Open Space/Recreation
- ag Agriculture
- f Forestry

- Area Added to UGA
- Incorporated Areas
- Proposed Urban Growth Boundary
- Urban Growth Boundary

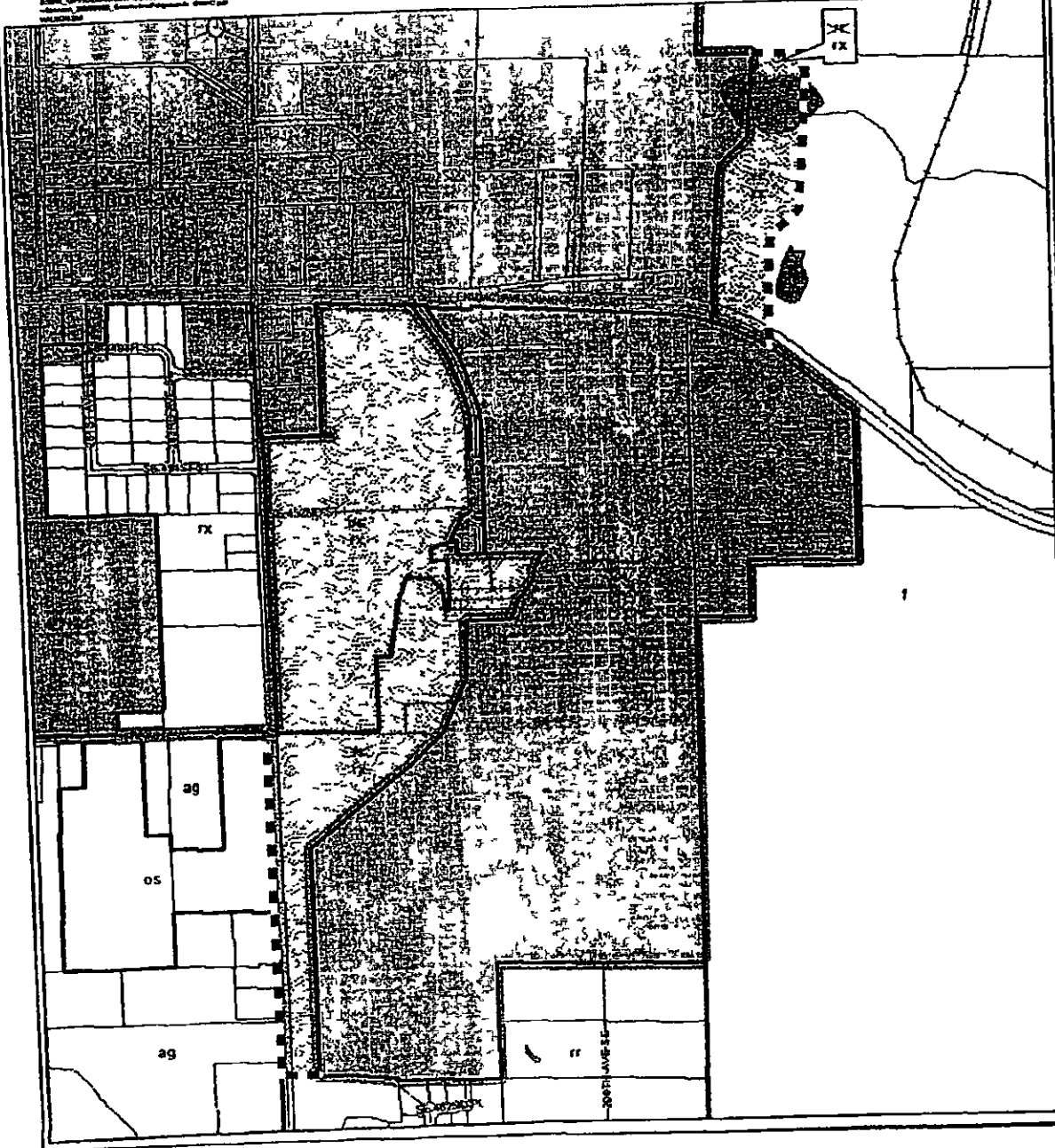



1st DNRP - Rock Creek Natural Area Land Use Map

The information indicated on this map has been compiled by King County and is based on records and is subject to change without notice. King County makes no representation or warranty, express or implied, as to accuracy, completeness, or rights in the use of such information. The information is provided for use as a general guide only. King County does not warrant for any liability, special, indirect, incidental, or consequential damages, including but not limited to, reasonable or best profit resulting from the use of records or the information, contained on this map. Any title of this map or information on this map is published except by written permission of King County.

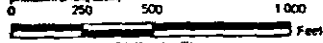

Revised: November 2, 2009
Map of 1st DNRP - Rock Creek Natural Area
Map of 1st DNRP - Rock Creek Natural Area
Map of 1st DNRP - Rock Creek Natural Area

Area Removed From UGA

Incorporated Areas

Urban Growth Boundary

Proposed Urban Growth Boundary

Rural Residential 1du/2.5-10acres

Open Space/ Recreation

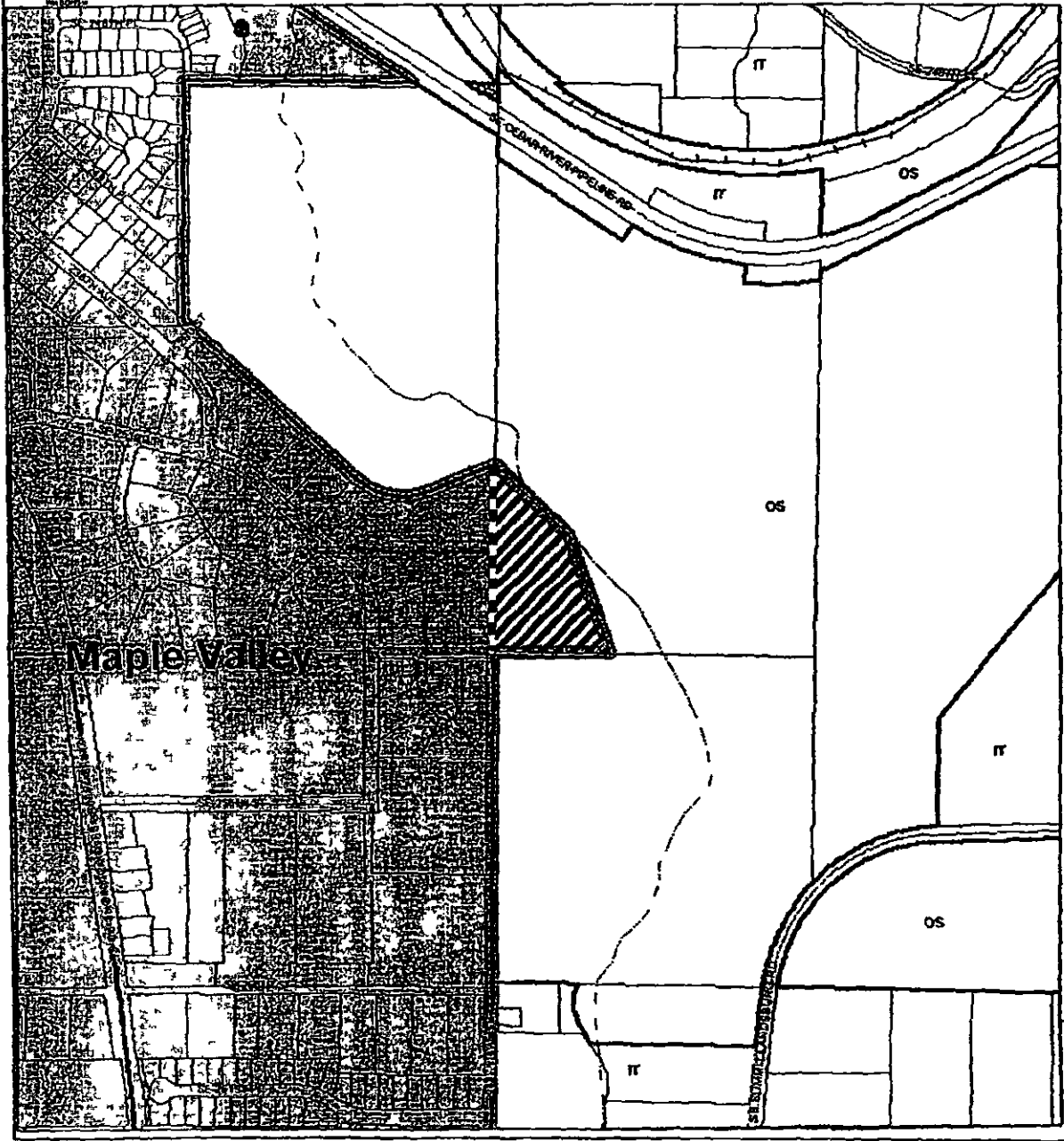



2nd DNRP - Crow Marsh Natural Area

Land Use Map



The information included on this map has been compiled by King County and does not constitute a warranty of accuracy and is subject to change without notice. King County makes no representation or warranty, express or implied, as to accuracy, completeness, or extent of any of such information. This document is not intended for use as a survey product. King County shall not be liable for any general, special, indirect, incidental, or consequential damages resulting, but not limited to, its use in connection with any project involving the use or abuse of the information contained on this map. Any use of this map or information on this map is prohibited except by written permission of King County.

0 250 500 1,000 Feet

DATE: November 19, 2008
PROJECT: 2nd DNRP - Crow Marsh Natural Area
DRAWN BY: [illegible]
CHECKED BY: [illegible]
APPROVED BY: [illegible]

- Area Removed From UGA
- Incorporated Areas
- Urban Growth Boundary
- Proposed Urban Growth Boundary
- Change Area

- IX Rural Cities Urban Growth Area
- OS Open Space/ Recreation
- f Forestry
- rr Rural Residential 1du/2.5-10acres

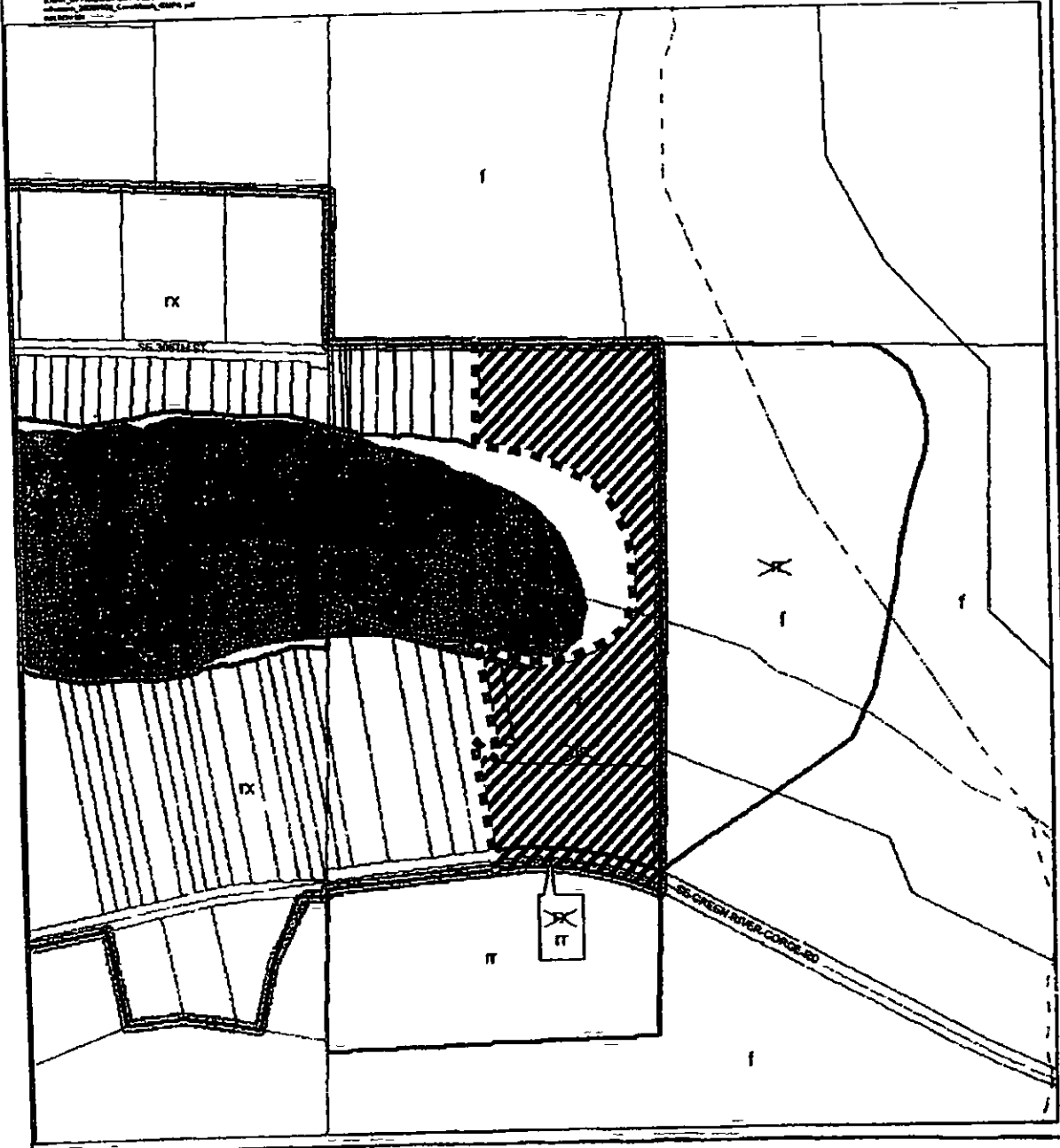





3rd DNRP - Dorre Don Reach Natural Area Land Use Map

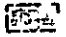

The information contained on this map has been compiled by King County and from various sources and is subject to change without notice. King County makes no representation or warranty, express or implied, as to accuracy, completeness, timeliness, or right to the use of such information. This document is not intended for use as a survey project. King County shall not be liable for any errors, omissions, or other inaccuracy, in whatever form, including but not limited to, text revision or text errors resulting from the use or reuse of the information contained on this map. Any sale of this map or information on any map is published solely by written permission of King County.

Scale: 1 inch = 300 feet
 Date: November 2008
 Prepared by: King County Department of Development and Environmental Services
 Contact: (206) 467-2200, ext. 4672

-  Area Removed From UGA
-  Incorporated Areas
-  Urban Growth Boundary
-  Proposed Urban Growth Boundary
- um Urban Residential Low 4-12du/acre
- OS Open Space/ Recreation
- I Industrial
- rr Rural Residential 1du/2.5-10acres

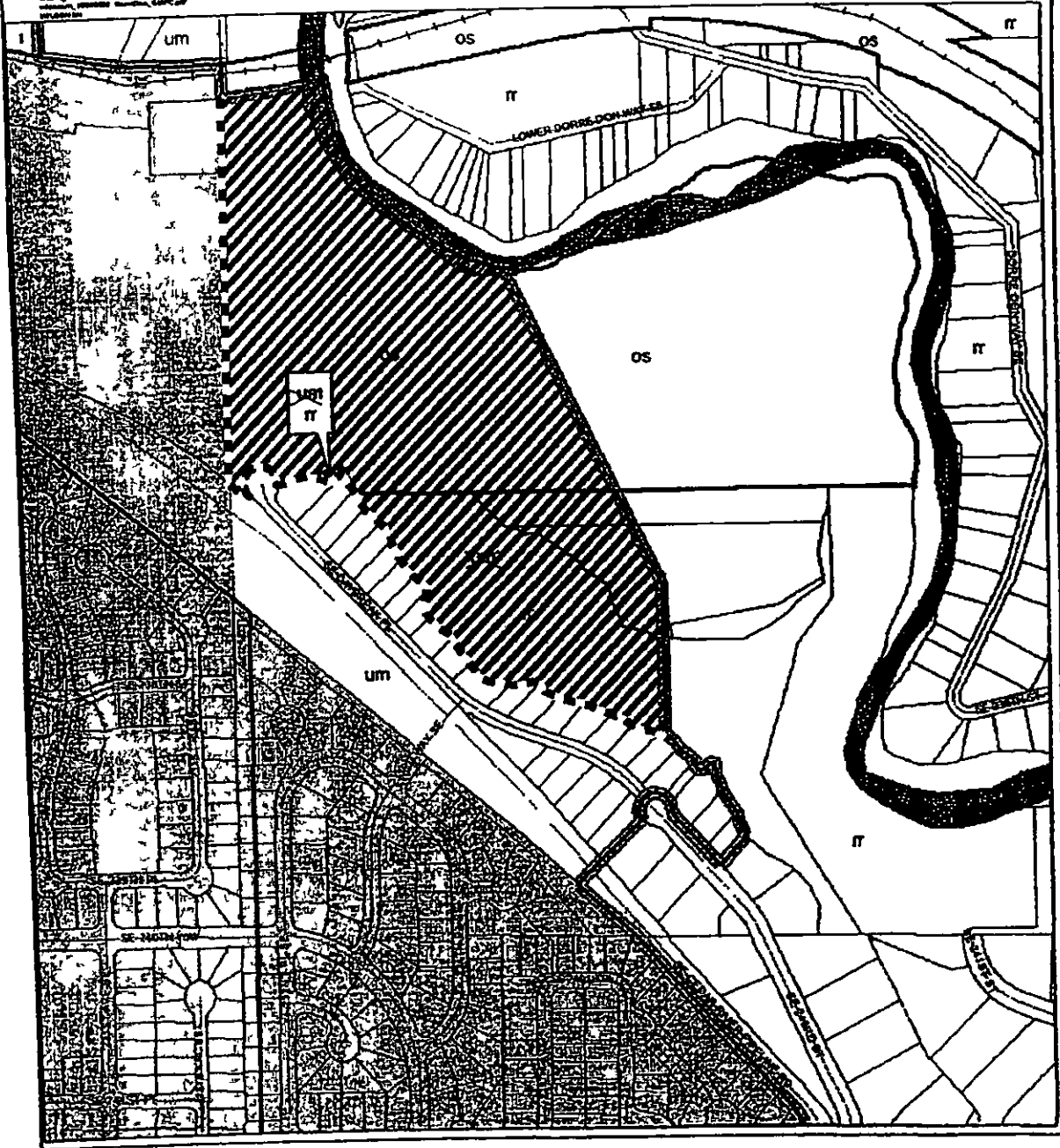



4th DNRP - Kathryn Taylor Land Use Map



The information contained on this map has been compiled by King County GISD from records of interest and is subject to change without notice. King County makes no representation or warranty, express or implied, as to accuracy, completeness, timeliness, or fitness for use of such information. The department is not liable for any errors or omissions. King County shall not be liable for any damages, including but not limited to, lost revenues or lost profits resulting from the use or reliance on the information contained on this map. Any sale of this map or information on this map is published except for the jurisdiction of King County.



Map Source: November 2, 2009 2:00 PM
Map Date: November 2, 2009 2:00 PM
Map Title: 4th DNRP - Kathryn Taylor
Map Author: GISD
Map Project: 4th DNRP - Kathryn Taylor
Map Date: November 2, 2009 2:00 PM
Map Title: 4th DNRP - Kathryn Taylor
Map Author: GISD
Map Project: 4th DNRP - Kathryn Taylor

- Incorporated Areas
- Urban Growth Boundary
- Area Removed From UGA
- Proposed Urban Growth Boundary
- OS Open Space/ Recreation
- upd Urban Planned Development
- rr Rural Residential 1du2 5-10acres

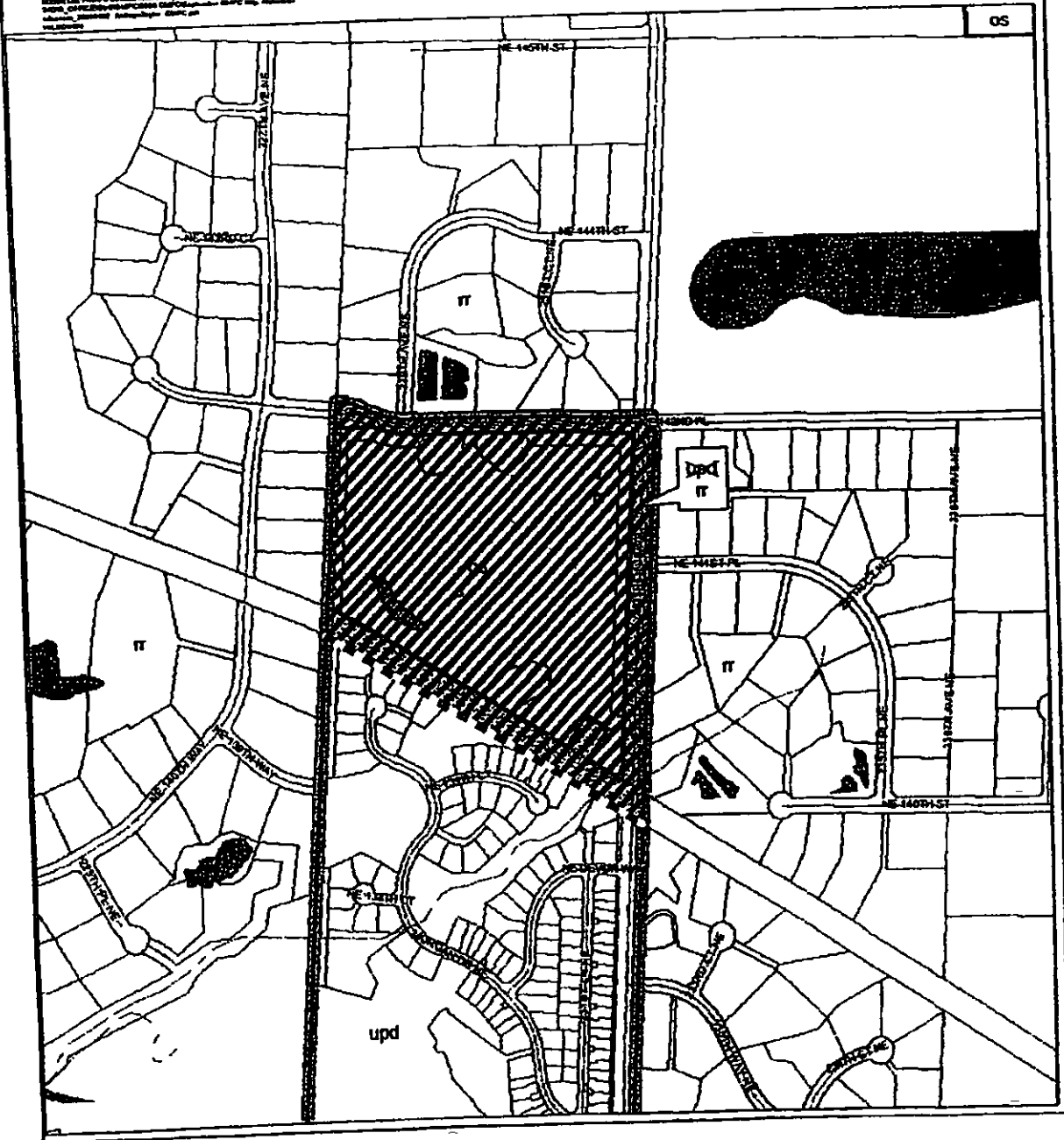





Maple Valley Technical Correction Land Use Map



The information included on this map has been compiled by King County and does not constitute an endorsement or warranty of any kind. King County makes no representation or warranty, express or implied, as to the accuracy, completeness, timeliness, or utility of the information. The information is not intended for use as a survey product. King County shall not be liable for any errors, omissions, or delays, or for any consequences arising from the use or reliance on the information contained on this map. Any use of the map or information on this map is published subject to the provisions of King County.



Last Printing: September 8, 2009 12:00 PM
C:\GIS\Projects\MapleValley\MapleValley_C2009.mxd
MapleValley_C2009.aprx
MapleValley_C2009.aprx
MapleValley_C2009.aprx
MapleValley_C2009.aprx

-  Incorporated Areas
-  Urban Growth Boundary
-  Area Removed From UGA

- OS Open Space/ Recreation
- UM Urban Residential Medium 4-12du/acre
- I Industrial
- rr Rural Residential 1du/2 5-10acres
- ag Agriculture

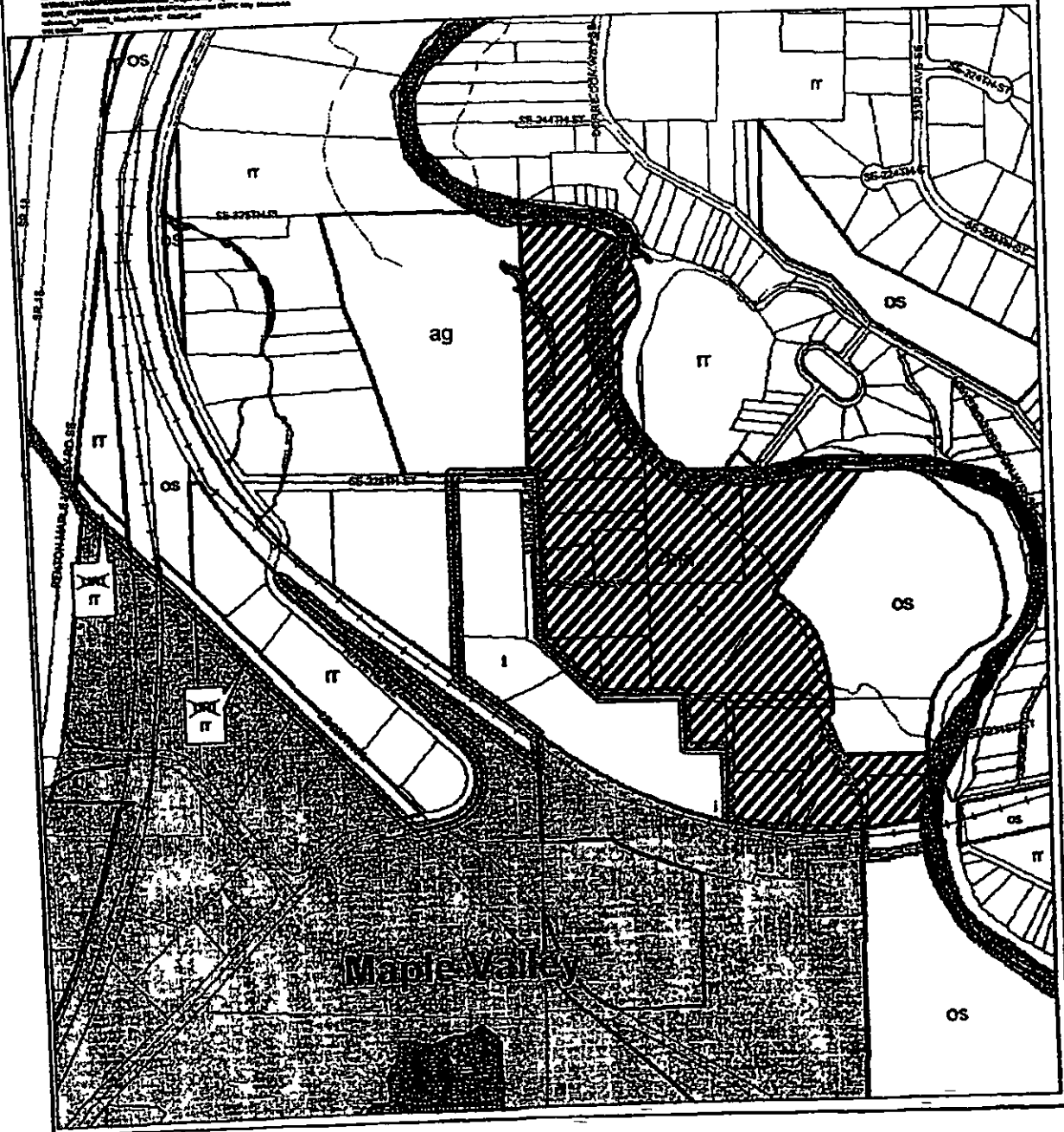



Black Diamond Technical Change Land Use Map



The information shown on this map has been compiled by King County. All boundaries shown are subject to change without notice. King County requires all incorporations, or amendments, requests or requests, as to territory, jurisdiction, boundaries, or rights, to the use of such information. The documents are intended for use by county officials. King County shall not be liable for any errors, omissions, or damages, including but not limited to, lost revenues or lost profits resulting from the use or misuse of the information contained on this map. Any use of this data or information on the map is prohibited except by written permission of King County.

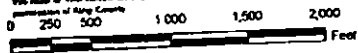

Date Revisory: September 2008 2042 PM
 KING COUNTY DEPARTMENT OF DEVELOPMENT AND ENVIRONMENTAL SERVICES
 3500 142ND AVENUE, SUITE 1000, BLACK DIAMOND, WA 98001
 TEL: 206.835.3000 FAX: 206.835.3001

- Incorporated Areas
- Urban Growth Boundary
- Proposed Urban Growth Boundary
- Area Added to UGA
- Area Removed From UGA

- m Mining
- f Forestry
- rr Rural Residential 1du/2.5-10acres
- rx Rural Cities Urban Growth Area

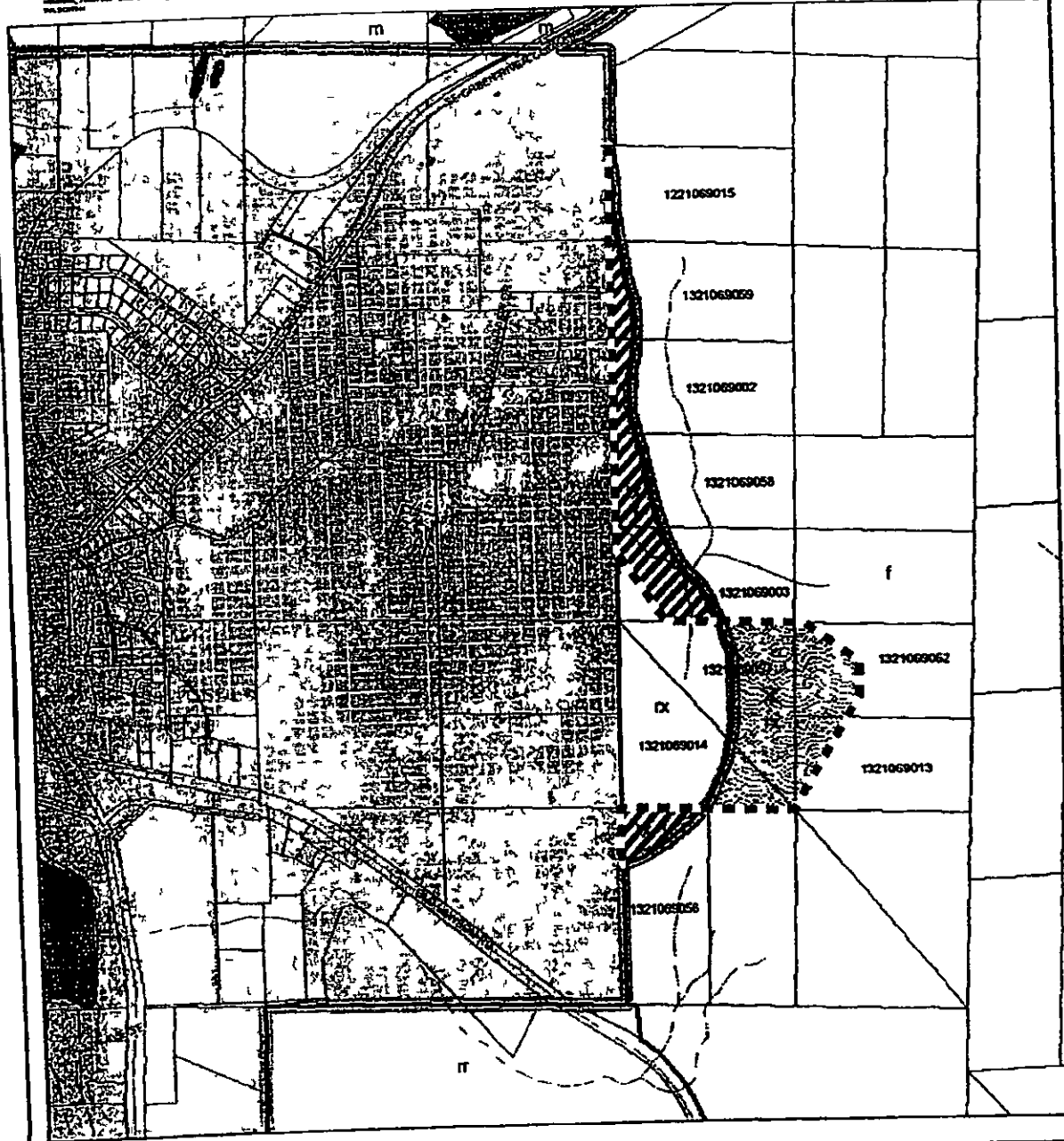



Lake Desire Subarea Plan

Land Use Map



The information contained on this map has been compiled by King County staff from a variety of sources and is intended to provide a general overview of the subarea. It is not intended to be used as a legal document. The information is not intended to be used as a legal document. The information is not intended to be used as a legal document. The information is not intended to be used as a legal document.

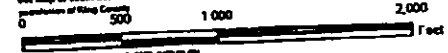

Scale: December 1, 2000 2000 1000 500 Feet

-  New Urban Separator
- gb Greenbelt/Urban Separator
- f Forestry
- rr Rural residential
- os Open space
- um Urban residential Medium 4-12du/ac.
- ul Urban residential Low 1du/ac.

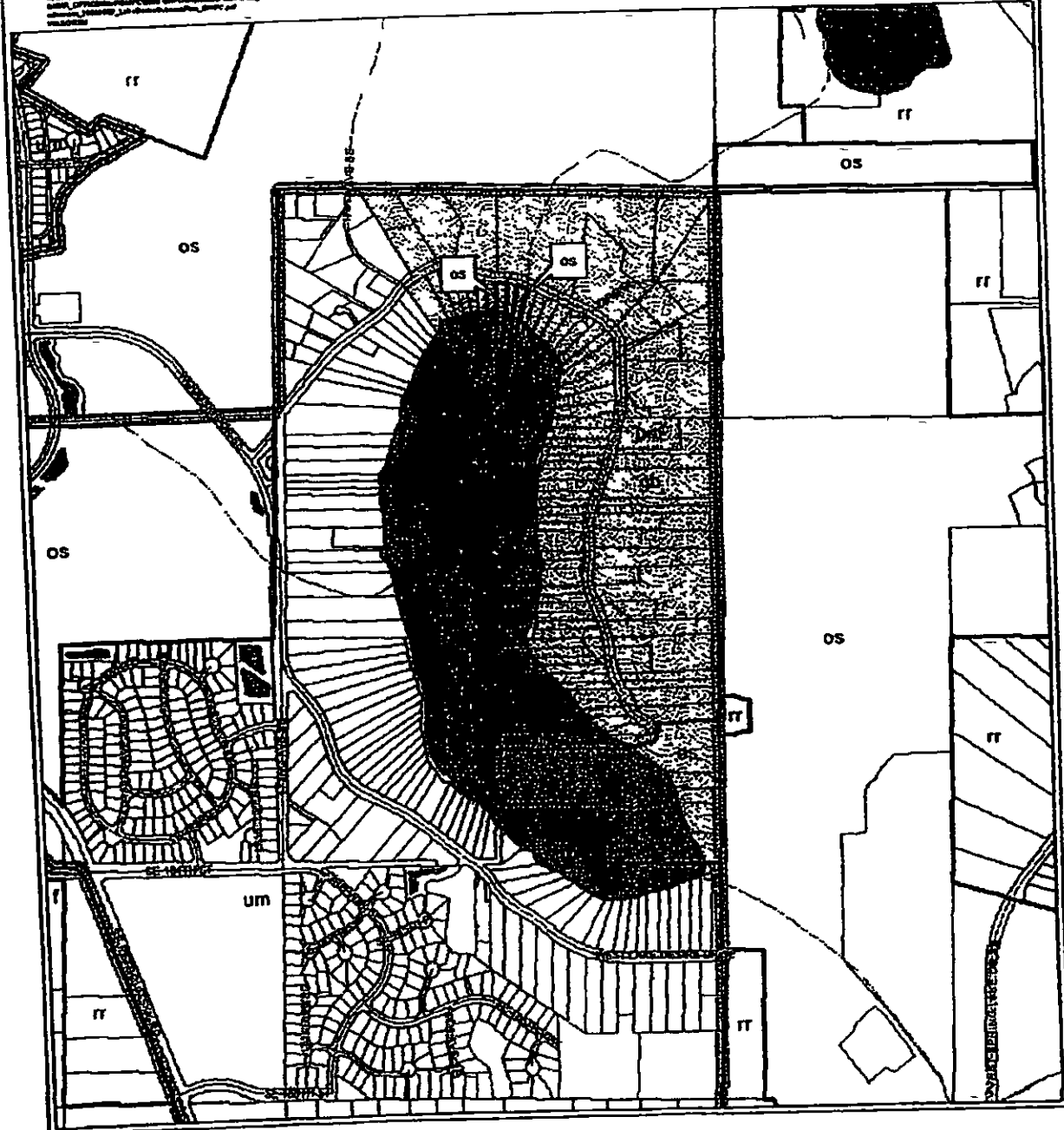



Eastridge Christian Assembly Land Use Map



The information contained on this map has been provided by King County staff based on maps of records and is intended to provide general information. King County makes no representation or warranty, express or implied, as to accuracy, completeness, or timeliness of the information. This document is not intended to be used as a legal instrument. King County does not bear liability for any errors, omissions, or inaccuracies, or for any damages, including but not limited to, lost revenues or lost profits resulting from the use or reliance on the information contained on this map. Any sale of this map or information on this map is prohibited except by written permission of King County.



Scale: 1 inch = 500 feet
Map Date: 10/15/2010
Map Author: King County GIS
Map Title: Eastridge Christian Assembly Land Use Map

- UL Urban Residential Low 1du/acre
- UM Urban Residential Medium 4 12du/acre
- RR Rural Residential
- OS King County Owned Open Space/Recreation

- Incorporated Areas
- Urban Growth Boundary
- Proposed Urban Growth Boundary
- Area Added to UGA

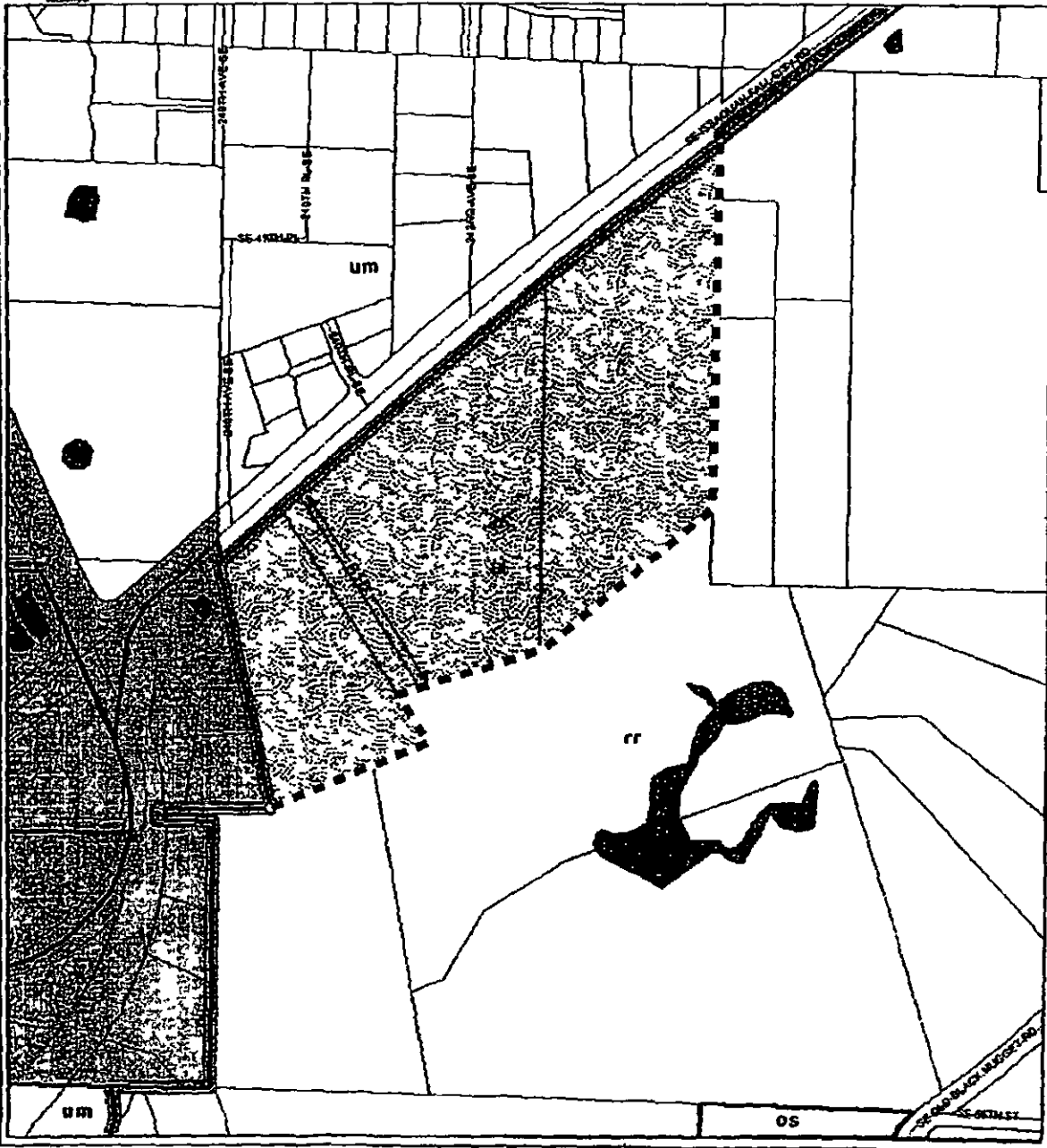



Duvall UGA Land Use Map



The information included on this map has been compiled by King County and does not constitute a representation or warranty of any kind. King County makes no representation or warranty, express or implied, as to the accuracy, completeness, timeliness, or utility of the information. This document is not intended for use as a survey product. King County staff will be liable for any general, special, indirect, incidental, or consequential damages including, but not limited to, loss of revenue or loss of profits arising from the use or reliance on the information contained on this map. Any sale of this map or information contained on this map is published except by written permission of King County.



Scale: Graphic, September 1, 2009, 42x28.5 in.
PROJECT: UGA Land Use Map, Duvall, ORCA
DATE: 09/01/2009 09:00:00 AM
DRAWN: [unclear]
CHECKED: [unclear]
APPROVED: [unclear]

- Area Added to Duvall Rural City UGA
- Incorporated Areas
- Urban Growth Boundary
- Proposed Urban Growth Boundary

- OS Open Space/ Recreation
- rx Rural Cities Urban Growth Area
- ag Agriculture
- rr Rural Residential 1du/2.5-10acres

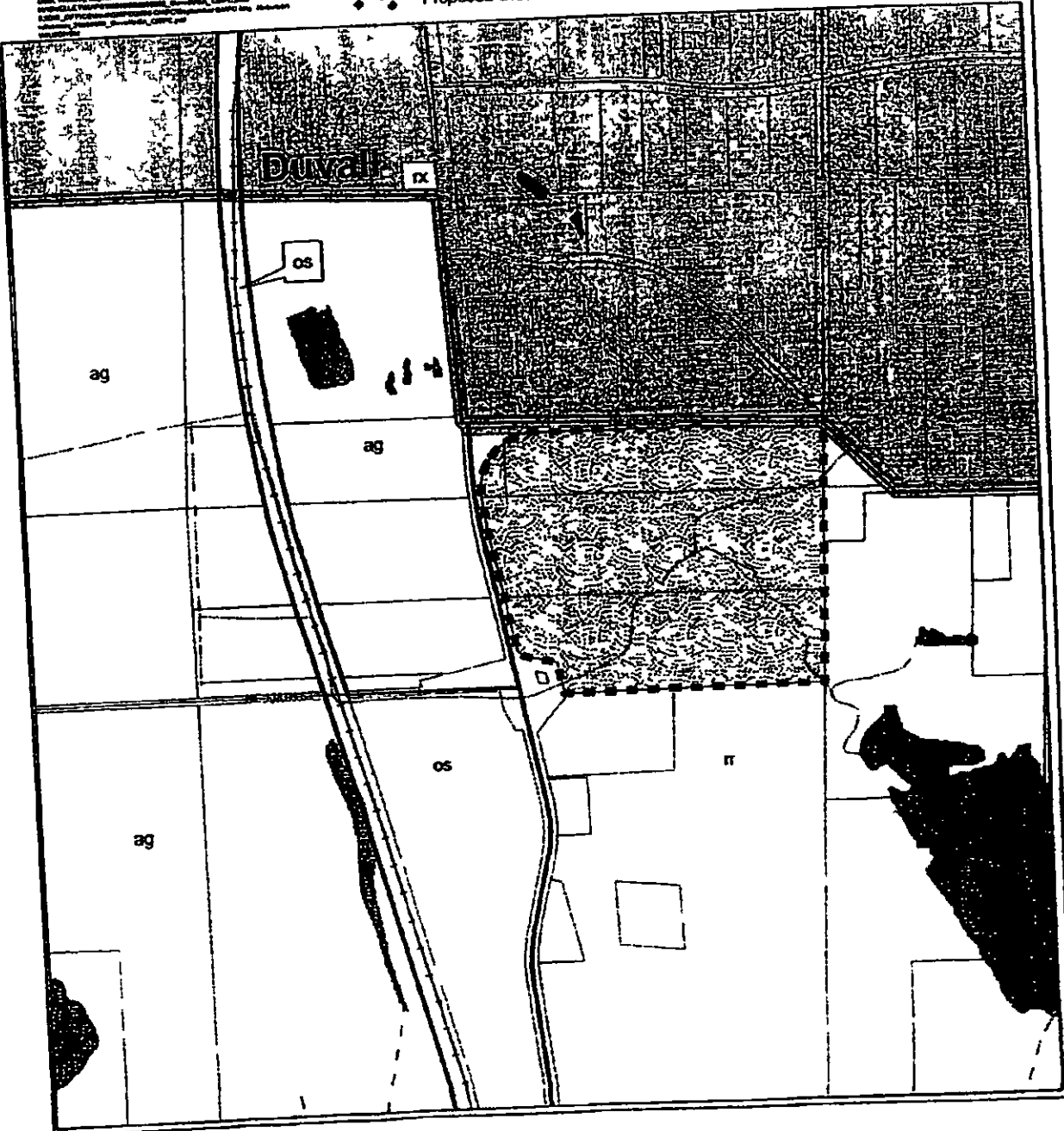



KING COUNTY

1200 King County Courthouse
516 Third Avenue
Seattle WA 98104

Signature Report

December 15, 2008

Ordinance 16335

Proposed No 2008 0621 2

Sponsors Gossett

1 AN ORDINANCE adopting amendments to the
2 Countywide Planning Policies, amending the interim
3 potential annexation areas map and ratifying the amended
4 Countywide Planning Policies for unincorporated King
5 County, and amending Ordinance 10450 Section 3, as
6 amended, and K.C.C. 20 10 030 and Ordinance 10450,
7 Section 4, as amended, and K.C.C. 20 10 040

8
9 BE IT ORDAINED BY THE COUNCIL OF KING COUNTY

10 SECTION 1 Findings The council makes the following findings

11 The Growth Management Planning Council met on October 2 2008 and voted to
12 recommend amendments to the King County Countywide Planning Policies amending
13 the interim potential annexation areas map as shown in Attachment A to this ordinance to
14 include a portion of unincorporated urban area within the Potential Annexation Area of
15 the city of Maple Valley

16 SECTION 2 Ordinance 10450, Section 3 as amended, and K.C.C. 20 10 030 are
17 each hereby amended to read as follows

18 A The Phase II Amendments to the King County 2012 Countywide Planning
19 Policies attached to Ordinance 11446 are hereby approved and adopted

20 B The Phase II Amendments to the King County 2012 Countywide Planning
21 Policies are amended, as shown by Attachment 1 to Ordinance 12027

22 C The Phase II Amendments to the King County 2012 - Countywide Planning
23 Policies are amended, as shown by Attachment 1 to Ordinance 12421

24 D The Phase II Amendments to the King County 2012 - Countywide Planning
25 Policies are amended, as shown by Attachments 1 and 2 to Ordinance 13260

26 E The Phase II Amendments to the King County 2012 - Countywide Planning
27 Policies are amended, as shown by Attachments 1 through 4 to Ordinance 13415

28 F The Phase II Amendments to the King County 2012 - Countywide Planning
29 Policies are amended, as shown by Attachments 1 through 3 to Ordinance 13858

30 G The Phase II Amendments to the King County 2012 – Countywide Planning
31 Policies are amended, as shown by Attachment 1 to Ordinance 14390

32 H The Phase II Amendments to the King County 2012 – Countywide Planning
33 Policies are amended, as shown by Attachment 1 to Ordinance 14391

34 I The Phase II Amendments to the King County 2012 – Countywide Planning
35 Policies are amended, as shown by Attachment 1 to Ordinance 14392

36 J The Phase II Amendments to the King County 2012 - Countywide Planning
37 Policies are amended, as shown by Attachment 1 to Ordinance 14652

38 K The Phase II Amendments to the King County 2012 - Countywide Planning
39 Policies are amended, as shown by Attachments 1 through 3 to Ordinance 14653

40 L The Phase II Amendments to the King County 2012 - Countywide Planning
41 Policies are amended, as shown by Attachment 1 to Ordinance 14654

42 M The Phase II Amendments to the King County 2012 - Countywide Planning
43 Policies are amended as shown by Attachment 1 to Ordinance 14655

44 N The Phase II Amendments to the King County 2012 - Countywide Planning
45 Policies are amended, as shown by Attachments 1 and 2 to Ordinance 14656

46 O The Phase II amendments to the King County 2012 – Countywide Planning
47 Policies are amended, as shown by Attachment A to Ordinance 14844

48 P The Phase II Amendments to the King County 2012 - Countywide Planning
49 Policies are amended as shown by Attachments A, B and C to Ordinance 15121

50 Q The Phase II Amendments to the King County 2012 - Countywide Planning
51 Policies are amended, as shown by Attachment A to Ordinance 15122

52 R. The Phase II Amendments to the King County 2012 - Countywide Planning
53 Policies are amended, as shown by Attachment A to Ordinance 15123

54 S Phase II Amendments to the King County 2012 - Countywide Planning
55 Policies are amended, as shown by Attachments A and B to Ordinance 15426

56 T Phase II Amendments to the King County 2012 - Countywide Planning
57 Policies are amended, as shown by Attachments A, B and C to Ordinance 15709

58 U Phase II Amendments to the King County 2012 - Countywide Planning
59 Policies are amended, as shown by Attachment A to Ordinance 16056

60 V Phase II Amendments to the King County 2012 - Countywide Planning
61 Policies are amended, as shown by Attachments A, B, C, D, E and F to Ordinance 16151

62 W Phase II Amendments to the King County 2012 - Countywide Planning

63 Policies are amended as shown by Attachment A to this ordinance.

64 SECTION 3 Ordinance 10450, Section 4, as amended, and K C C 20 10 040 are
65 each hereby amended to read as follows

66 A Countywide Planning Policies adopted by Ordinance 10450 for the purposes
67 specified are hereby ratified on behalf of the population of unincorporated King County

68 B The amendments to the Countywide Planning Policies adopted by Ordinance
69 10840 are hereby ratified on behalf of the population of unincorporated King County

70 C The amendments to the Countywide Planning Policies adopted by Ordinance
71 11061 are hereby ratified on behalf of the population of unincorporated King County

72 D The Phase II amendments to the King County 2012 Countywide Planning
73 Policies adopted by Ordinance 11446 are hereby ratified on behalf of the population of
74 unincorporated King County

75 E The amendments to the King County 2012 - Countywide Planning Policies, as
76 shown by Attachment 1 to Ordinance 12027 are hereby ratified on behalf of the
77 population of unincorporated King County

78 F The amendments to the King County 2012 - Countywide Planning Policies, as
79 shown by Attachment 1 to Ordinance 12421, are hereby ratified on behalf of the
80 population of unincorporated King County

81 G The amendments to the King County 2012 - Countywide Planning Policies, as
82 shown by Attachments 1 and 2 to Ordinance 13260, are hereby ratified on behalf of the
83 population of unincorporated King County

84 H The amendments to the King County 2012 - Countywide Planning Policies, as
85 shown by Attachment 1 through 4 to Ordinance 13415, are hereby ratified on behalf of
86 the population of unincorporated King County

87 I The amendments to the King County 2012 - Countywide Planning Policies, as
88 shown by Attachments 1 through 3 to Ordinance 13858, are hereby ratified on behalf of
89 the population of unincorporated King County

90 J The amendments to the King County 2012 - Countywide Planning Policies, as
91 shown by Attachment 1 to Ordinance 14390, are hereby ratified on behalf of the
92 population of unincorporated King County

93 K The amendments to the King County 2012 - Countywide Planning Policies as
94 shown by Attachment 1 to Ordinance 14391, are hereby ratified on behalf of the
95 population of unincorporated King County

96 L The amendments to the King County 2012 - Countywide Planning Policies, as
97 shown by Attachment 1 to Ordinance 14392, are hereby ratified on behalf of the
98 population of unincorporated King County

99 M The amendments to the King County 2012 - Countywide Planning Policies, as
100 shown by Attachment 1 to Ordinance 14652, are hereby ratified on behalf of the
101 population of unincorporated King County

102 N The amendments to the King County 2012 - Countywide Planning Policies, as
103 shown by Attachments 1 through 3 to Ordinance 14653, are hereby ratified on behalf of
104 the population of unincorporated King County

105 O The amendments to the King County 2012 - Countywide Planning Policies as
106 shown by Attachment 1 to Ordinance 14654 are hereby ratified on behalf of the
107 population of unincorporated King County

108 P The amendments to the King County 2012 - Countywide Planning Policies, as
109 shown by Attachment 1 to Ordinance 14655, are hereby ratified on behalf of the
110 population of unincorporated King County

111 Q The amendments to the King County 2012 - Countywide Planning Policies, as
112 shown by Attachments 1 and 2 to Ordinance 14656, are hereby ratified on behalf of the
113 population of unincorporated King County

114 R The amendments to the King County 2012 - Countywide Planning Policies, as
115 shown by Attachment A to Ordinance 14844, are hereby ratified on behalf of the
116 population of unincorporated King County

117 S The amendments to the King County 2012 - Countywide Planning Policies, as
118 shown by Attachments A, B and C to Ordinance 15121, are hereby ratified on behalf of
119 the population of unincorporated King County

120 T The amendments to the King County 2012 - Countywide Planning Policies, as
121 shown by Attachment A to Ordinance 15122, are hereby ratified on behalf of the
122 population of unincorporated King County

123 U The amendments to the King County 2012 - Countywide Planning Policies, as
124 shown by Attachment A to Ordinance 15123, are hereby ratified on behalf of the
125 population of unincorporated King County

Ordinance 16335

126 V The amendments to the King County 2012 - Countywide Planning Policies, as
127 shown by Attachments A and B to Ordinance 15426, are hereby ratified on behalf of the
128 population of unincorporated King County

129 W The amendments to the King County 2012 - Countywide Planning Policies,
130 as shown by Attachments A, B and C to Ordinance 15709, are hereby ratified on behalf
131 of the population of unincorporated King County

132 X The amendments to the King County 2012 - Countywide Planning Policies, as
133 shown by Attachment A to Ordinance 16056, are hereby ratified on behalf of the
134 population of unincorporated King County

135 Y The amendments to the King County 2012 - Countywide Planning Policies, as
136 shown by Attachments A, B, C, D, E and F to Ordinance 16151, are hereby ratified on
137 behalf of the population of unincorporated King County

138 Z The amendments to the King County 2012 - Countywide Planning Policies, as

139

Ordinance 16335

140 shown by Attachment A to this ordinance are hereby ratified on behalf of the population

141 of unincorporated King County

142

Ordinance 16335 was introduced on 12/8/2008 and passed by the Metropolitan King County Council on 12/15/2008, by the following vote

Yes 7 - Ms Patterson, Mr Constantine, Ms Lambert Mr von Reichbauer
Mr Ferguson, Mr Gossett and Mr Phillips
No 0
Excused 2 - Mr Dunn and Ms Hague

KING COUNTY COUNCIL
KING COUNTY WASHINGTON

Julia Patterson, Chair

ATTEST

Anne Norris Clerk of the Council

RECEIVED
2008 DEC 24 AM 9 00
CLERK
KING COUNTY COUNCIL

APPROVED this 23 day of December 2008

Ron Sims County Executive

Attachments A Motion 08-7 revised 12/09/08

Attachment A
Revised 12/09/08

10/02/08

Sponsored By

Executive Committee

/pr

MOTION NO 08-7

A MOTION to amend the Urban Growth Area of King County This Motion also modifies the Potential Annexation Area map in the Countywide Planning Policies and designates a new Urban Separator

WHEREAS, the Washington State Growth Management Act RCW 36 70A.110 requires counties to designate an urban growth area or areas within which urban growth shall be encouraged and outside of which growth can occur only if it is not urban in nature, and

WHEREAS, Countywide Planning Policy FW-1 Step 8 recognizes that King County may initiate amendments to the Urban Growth Area, and

WHEREAS the King County Executive and the Metropolitan King County Council requests the Growth Management Planning Council consider the attached amendments to the Urban Growth Area for eventual adoption by the Metropolitan King County Council and ratification by the cities, and

WHEREAS, the Growth Management Planning Council has directed the interjurisdictional staff team to review additional Urban Separators and present them for GMPC consideration, and

WHEREAS, Countywide Planning Policies LU-31 and LU-32 anticipate the collaborative designation of Potential Annexation Areas and the eventual annexation of these areas by cities The attached amendments are supported by the affected city

BE IT RESOLVED THAT THE GROWTH MANAGEMENT PLANNING COUNCIL OF KING COUNTY HEREBY MOVES AS FOLLOWS

- 1 Amend the Urban Growth Area as designated by the Urban Growth Areas Map in the Countywide Planning Policies, the Potential Annexation Area map, and the Urban Separator map as depicted on the following attached maps.

1
2
3
4
5
6
7
8
9
10
11
12
13
14
15
16
17
18
19
20

Attachment 1 Maple Valley Summit Pit

2. Amend the Interim Potential Annexation Area Map by including any additional unincorporated urban land created by these UGA amendments in the Potential Annexation Area of the adjoining city and deleting any land changed from urban to rural from the respective PAA
- 3 These amendments are recommended to the Metropolitan King County Council and the Cities of King County for adoption and ratification.

ADOPTED by the Growth Management Planning Council of King County in open session on October 2, 2008 and signed by the chair of the GMPC



Ron Sims, Chair, Growth Management Planning Council



KING COUNTY

1200 King County Courthouse
516 Third Avenue
Seattle WA 98104

Signature Report

December 15, 2008

Ordinance 16336

Proposed No 2008 0622 2

Sponsors Gossett

1 AN ORDINANCE adopting amendments to the
2 Countywide Planning Policies, amending the interim
3 potential annexation areas map and ratifying the amended
4 Countywide Planning Policies for unincorporated King
5 County; and amending Ordinance 10450, Section 3 as
6 amended, and K C C 20 10 030 and Ordinance 10450,
7 Section 4, as amended, and K C C 20 10 040

8

9 BE IT ORDAINED BY THE COUNCIL OF KING COUNTY

10 SECTION 1 Findings The council makes the following findings

11 As part of the King County council's review of the 2008 Comprehensive Plan
12 updates the council adopted amendment to the Urban Growth Boundary near the city of
13 Black Diamond as set forth in Attachment A to this ordinance

14 SECTION 2 Ordinance 10450, Section 3, as amended, and K C C 20 10 030 are
15 each hereby amended to read as follows

16 A The Phase II Amendments to the King County 2012 Countywide Planning
17 Policies attached to Ordinance 11446 are hereby approved and adopted

18 B The Phase II Amendments to the King County 2012 - Countywide Planning
19 Policies are amended, as shown by Attachment 1 to Ordinance 12027

20 C The Phase II Amendments to the King County 2012 - Countywide Planning
21 Policies are amended, as shown by Attachment 1 to Ordinance 12421

22 D The Phase II Amendments to the King County 2012 - Countywide Planning
23 Policies are amended as shown by Attachments 1 and 2 to Ordinance 13260

24 E The Phase II Amendments to the King County 2012 - Countywide Planning
25 Policies are amended, as shown by Attachments 1 through 4 to Ordinance 13415

26 F The Phase II Amendments to the King County 2012 - Countywide Planning
27 Policies are amended, as shown by Attachments 1 through 3 to Ordinance 13858

28 G The Phase II Amendments to the King County 2012 - Countywide Planning
29 Policies are amended, as shown by Attachment 1 to Ordinance 14390

30 H The Phase II Amendments to the King County 2012 - Countywide Planning
31 Policies are amended, as shown by Attachment 1 to Ordinance 14391

32 I The Phase II Amendments to the King County 2012 - Countywide Planning
33 Policies are amended, as shown by Attachment 1 to Ordinance 14392

34 J The Phase II Amendments to the King County 2012 - Countywide Planning
35 Policies are amended, as shown by Attachment 1 to Ordinance 14652

36 K The Phase II Amendments to the King County 2012 - Countywide Planning
37 Policies are amended, as shown by Attachments 1 through 3 to Ordinance 14653

38 L The Phase II Amendments to the King County 2012 - Countywide Planning
39 Policies are amended, as shown by Attachment 1 to Ordinance 14654

40 M The Phase II Amendments to the King County 2012 - Countywide Planning
41 Policies are amended as shown by Attachment 1 to Ordinance 14655

42 N The Phase II Amendments to the King County 2012 - Countywide Planning
43 Policies are amended, as shown by Attachments 1 and 2 to Ordinance 14656

44 O The Phase II amendments to the King County 2012 - Countywide Planning
45 Policies are amended, as shown by Attachment A to Ordinance 14844

46 P The Phase II Amendments to the King County 2012 - Countywide Planning
47 Policies are amended as shown by Attachments A, B and C to Ordinance 15121

48 Q The Phase II Amendments to the King County 2012 - Countywide Planning
49 Policies are amended, as shown by Attachment A to Ordinance 15122

50 R The Phase II Amendments to the King County 2012 Countywide Planning
51 Policies are amended, as shown by Attachment A to Ordinance 15123

52 S Phase II Amendments to the King County 2012 - Countywide Planning
53 Policies are amended as shown by Attachments A and B to Ordinance 15426

54 T Phase II Amendments to the King County 2012 - Countywide Planning
55 Policies are amended, as shown by Attachments A, B and C to Ordinance 15709

56 U Phase II Amendments to the King County 2012 - Countywide Planning
57 Policies are amended, as shown by Attachment A to Ordinance 16056

58 V Phase II Amendments to the King County 2012 - Countywide Planning
59 Policies are amended, as shown by Attachments A, B, C D, E and F to Ordinance 16151

60 W Phase II Amendments to the King County 2012 - Countywide Planning
61 Policies are amended as shown by Attachment A to this ordinance

62 **SECTION 3** Ordinance 10450, Section 4, as amended, and K.C C 20 10 040 are
63 each hereby amended to read as follows

64 A Countywide Planning Policies adopted by Ordinance 10450 for the purposes
65 specified are hereby ratified on behalf of the population of unincorporated King County

66 B The amendments to the Countywide Planning Policies adopted by Ordinance
67 10840 are hereby ratified on behalf of the population of unincorporated King County

68 C The amendments to the Countywide Planning Policies adopted by Ordinance
69 11061 are hereby ratified on behalf of the population of unincorporated King County

70 D The Phase II amendments to the King County 2012 Countywide Planning
71 Policies adopted by Ordinance 11446 are hereby ratified on behalf of the population of
72 unincorporated King County

73 E The amendments to the King County 2012 - Countywide Planning Policies, as
74 shown by Attachment 1 to Ordinance 12027 are hereby ratified on behalf of the
75 population of unincorporated King County

76 F The amendments to the King County 2012 - Countywide Planning Policies, as
77 shown by Attachment 1 to Ordinance 12421, are hereby ratified on behalf of the
78 population of unincorporated King County

79 G The amendments to the King County 2012 - Countywide Planning Policies, as
80 shown by Attachments 1 and 2 to Ordinance 13260, are hereby ratified on behalf of the
81 population of unincorporated King County

82 H The amendments to the King County 2012 - Countywide Planning Policies, as
83 shown by Attachment 1 through 4 to Ordinance 13415 are hereby ratified on behalf of
84 the population of unincorporated King County

85 I The amendments to the King County 2012 Countywide Planning Policies as
86 shown by Attachments 1 through 3 to Ordinance 13858 are hereby ratified on behalf of
87 the population of unincorporated King County

88 J The amendments to the King County 2012 - Countywide Planning Policies as
89 shown by Attachment 1 to Ordinance 14390, are hereby ratified on behalf of the
90 population of unincorporated King County

91 K The amendments to the King County 2012 - Countywide Planning Policies, as
92 shown by Attachment 1 to Ordinance 14391, are hereby ratified on behalf of the
93 population of unincorporated King County

94 L The amendments to the King County 2012 - Countywide Planning Policies as
95 shown by Attachment 1 to Ordinance 14392, are hereby ratified on behalf of the
96 population of unincorporated King County

97 M The amendments to the King County 2012 - Countywide Planning Policies as
98 shown by Attachment 1 to Ordinance 14652, are hereby ratified on behalf of the
99 population of unincorporated King County

100 N The amendments to the King County 2012 Countywide Planning Policies, as
101 shown by Attachments 1 through 3 to Ordinance 14653, are hereby ratified on behalf of
102 the population of unincorporated King County

103 O The amendments to the King County 2012 - Countywide Planning Policies as
104 shown by Attachment 1 to Ordinance 14654, are hereby ratified on behalf of the
105 population of unincorporated King County

106 P The amendments to the King County 2012 Countywide Planning Policies, as
107 shown by Attachment 1 to Ordinance 14655 are hereby ratified on behalf of the
108 population of unincorporated King County

109 Q The amendments to the King County 2012 - Countywide Planning Policies, as
110 shown by Attachments 1 and 2 to Ordinance 14656, are hereby ratified on behalf of the
111 population of unincorporated King County

112 R The amendments to the King County 2012 – Countywide Planning Policies, as
113 shown by Attachment A to Ordinance 14844, are hereby ratified on behalf of the
114 population of unincorporated King County

115 S The amendments to the King County 2012 - Countywide Planning Policies, as
116 shown by Attachments A, B and C to Ordinance 15121, are hereby ratified on behalf of
117 the population of unincorporated King County

118 T The amendments to the King County 2012 - Countywide Planning Policies, as
119 shown by Attachment A to Ordinance 15122 are hereby ratified on behalf of the
120 population of unincorporated King County

121 U The amendments to the King County 2012 - Countywide Planning Policies, as
122 shown by Attachment A to Ordinance 15123, are hereby ratified on behalf of the
123 population of unincorporated King County

124 V The amendments to the King County 2012 - Countywide Planning Policies, as
125 shown by Attachments A and B to Ordinance 15426, are hereby ratified on behalf of the
126 population of unincorporated King County

127 W The amendments to the King County 2012 - Countywide Planning Policies
128 as shown by Attachments A, B and C to Ordinance 15709, are hereby ratified on behalf
129 of the population of unincorporated King County

130 X The amendments to the King County 2012 - Countywide Planning Policies, as
131 shown by Attachment A to Ordinance 16056, are hereby ratified on behalf of the
132 population of unincorporated King County

133 Y The amendments to the King County 2012 - Countywide Planning Policies as
134 shown by Attachments A, B, C, D, E and F to Ordinance 16151, are hereby ratified on
135 behalf of the population of unincorporated King County

136 Z The amendment to the King County 2012 - Countywide Planning Policies, as
137 shown by Attachment A of this ordinance, is hereby ratified on behalf of the population
138 of unincorporated King County. Additionally, by this ordinance, an amendment to the
139 Interim Potential Annexation Area Map to include any additional unincorporated urban
140 land created by the Urban Growth Area (UGA) amendment in the Potential Annexation

141

142 Area of the city of Black Diamond is hereby ratified on behalf of the population of

143 unincorporated King County

144

Ordinance 16336 was introduced on 12/8/2008 and passed by the Metropolitan King County Council on 12/15/2008, by the following vote

Yes 7 - Ms Patterson Mr Constantine, Ms Lambert, Mr von Reichbauer,
Mr Ferguson, Mr Gossett and Mr Phillips
No 0
Excused 2 - Mr Dunn and Ms Hague

KING COUNTY COUNCIL
KING COUNTY WASHINGTON

Julia Patterson, Chair

ATTEST

Anne Nors Clerk of the Council

APPROVED this 23 day of December 2008

Ron Sims County Executive

RECEIVED
2008 DEC 24 AM 9 01
KING COUNTY COUNCIL

Attachments A. Map Amendment 29

Map Amendment 29

Reserve at Covington Creek UGA

1
2
3
4
5
6
7
8
9
10
11
12
13
14
15
16
17
18
19
20
21
22

AMENDMENT TO THE KING COUNTY COMPREHENSIVE PLAN – LAND USE
MAP

Amend Map #22, Section 4 Township 21, Range 6 as follows

Redesignate the following parcels from Rural Residential to Rural City Urban Growth
Area.

- 0421069008
- 0421069011
- 0421069106

Amend all other KCCP and Technical Appendix maps that include the Urban Growth
Area to be consistent with this change

Effect Adds approximately 51 09 acres to the Urban Growth Area near the city of Black
Diamond 11 acres – Kentlake Athletic Field and 40 09 acres – Reserve at Covington
Creek



Reserve at Covington Creek Land Use Map



The information shown on this map has been compiled by King County and is intended to provide a general overview of the land use design. It is not intended to be used as a legal document. For more information, please contact King County Planning and Development Services at 3100 1st Avenue, Suite 200, Seattle, WA 98101. Phone: (206) 462-3300. Fax: (206) 462-3301. Website: www.kingcounty.gov/planning



 Incorporated Areas

 Urban Growth Boundary

 Proposed Urban Growth Boundary

 Change Area

 Rural Residential 1 du/2.5 - 10 acres

 Rural City Urban Growth Area

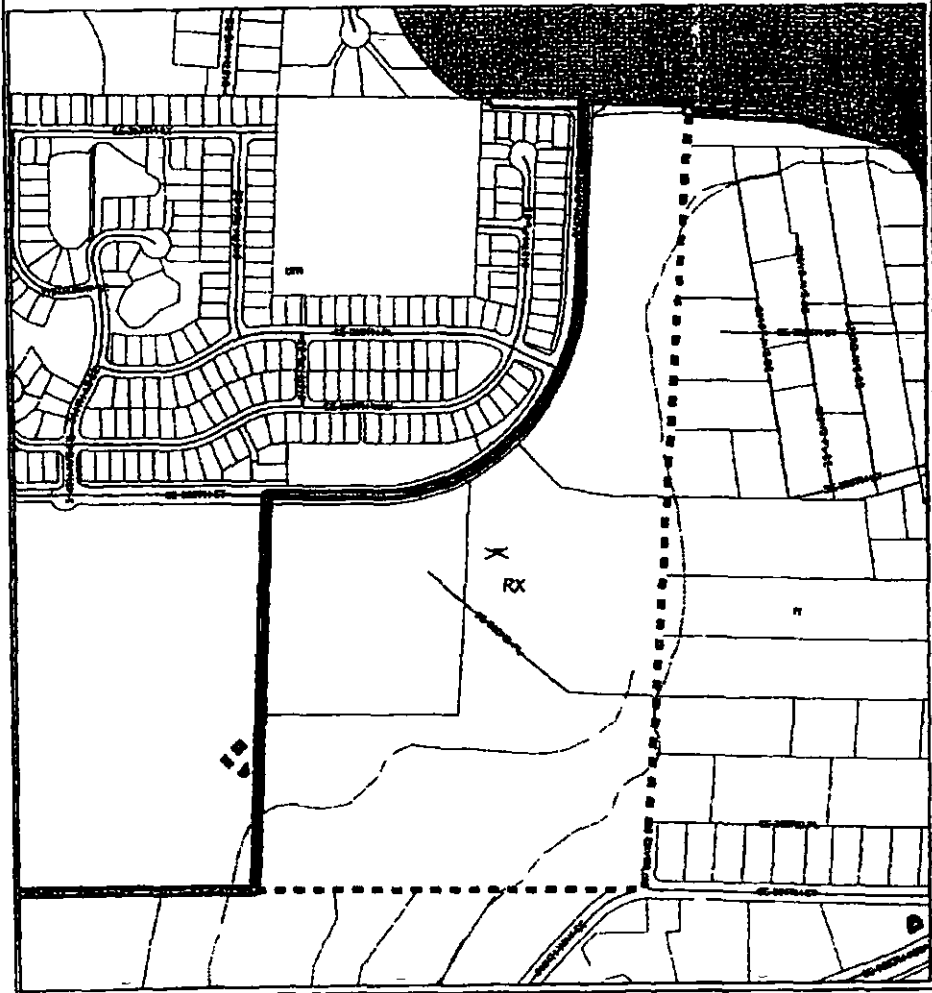

Map Amendment 29

Reserve at Covington Creek UGA

AMENDMENT TO THE KING COUNTY ZONING ATLAS

Amend Map #22 Section 4 Township 21, Range 6 as follows

Reclassify parcel 0421069106 from RA-5 to R-4

Reclassify parcels 0421069008 and 0421069011 from RA-5 to UR-P, subject to the following p-suffix conditions

- Development shall be consistent with all City of Black Diamond plans, regulation and guidelines,
- King County and any development applicant shall address traffic in the area to ensure existing conditions are addressed and improved – not degraded – by any future development, and
- The applicant shall enter into a pre-annexation agreement that includes the use of rural transfer of development rights and the conservation of at least four acres of rural land for every acre of urban land

Effect:

- Rezones 51 09 acres from RA-5 near the city of Black Diamond, as follows 11 acres of R-4 zoning for Kentlake Athletic Field and 40 09 acres of UR zoning for Reserve at Covington Creek
- Adds a p-suffix to any future urban development on the Reserve at Covington Creek requiring consistency with city of Black Diamond plans, regulations and standards and addressing and improving future traffic conditions, as well as, requiring a pre-annexation agreement including the use of TDRs to conserve 4 acres of rural land for each new acre of urban land







Reserve at Covington Creek Zoning Map

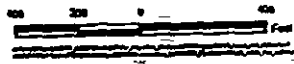

The information included on this map has been prepared by King County and does not constitute a warranty or representation of any kind. King County does not warrant the accuracy or completeness of the information included on this map. King County does not warrant the accuracy or completeness of the information included on this map. King County does not warrant the accuracy or completeness of the information included on this map.



-  Incorporated Areas
-  Urban Growth Boundary
-  Proposed Urban Growth Boundary
-  Change Area

UR Urban Reserve
 RA-5 Rural Area, 1 du/5 acres

